

AOLE SAFETY EQUIPMENT

The Guide To Life Safety, Your Emergency Warning Light



Tel: 86-577-88631800
86-577-88810150
Fax: 86-577-88636556
E-mail: aole.yee@chinaaole.com
Website: www.wzaole.com
Add: No.398,hualongqiao Road, WenzhouCity,
ZhejiangProvince.China



Our Business Partner :



Our Global Exhibition:



CONTENTS

◆ Lightbar Series	1
◆ Beacon Series	13
◆ Moto-Light Series	33
◆ Arrow Board Series	37
◆ Siren&Speaker Series	47
◆ Vehicle-Mounted Mobile Telescopic Lighting Equipment Series	55
◆ Police Helmet Series	59
◆ LED Display	60
◆ Parking Signal For School Bus	60



CNCA-R-2002-013

► About us

Our company is located in Wenzhou city which is about 500kms far from shanghai. With more than 30 years experience in safety equipment industry,we are a dynamic and highly professional manufacturer of electronic lighting and signal products for emergency, safety, maintenance, utility and public transportation vehicles. Our products range includes light bars, beacons, sirens and police equipment series. There are more than 100 employees and possesses powerful R & D and manufacturing capabilities. With superior product quality, thorough quality assurance system and rapid sales, more than 100 sales networks and supporting relationships with over 20 automobile factories around China have been built. As an aggressive team, we also have distributed our products to Europe, USA, Middle East and Africa. Based on our rich experiences, our expertise will continue to be provided to the public sector and the private enterprise at home and abroad with a whole set of technical support, project design, installation and after-sales service. We always keep creating new products and improving existing products and processes. Customer's satisfaction is our priority. We will be your No. 1 source for the warning signal product.



LIGHTBAR SERIES

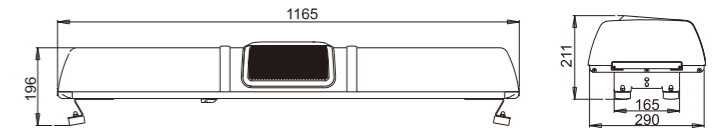

TBD-1000 Series Lightbar

Model	Rated Voltage (V)	Power (w)	Ambient temperature	LED	Flash settings	IP	Length(mm)	Net weight(kg)	Color	Speaker
TBD-10L8A-46	DC12V/24V	≤35W	-40°C — +75°C	8pcs	1-4HZ	65	1165	11.2	● ● ● ○	Available

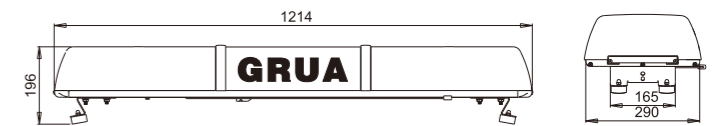

TBD-1000 Series Lightbar

Model	Rated Voltage (V)	Power (w)	Ambient temperature	Halogen	Flash settings	IP	Length(mm)	Net weight(kg)	Color	Speaker
TBD-10R4P-48	DC12V/24V	≤160	-40°C — +75°C	4pcs	1-4HZ	65	1214	11.2	● ● ● ○	Not available
TBD-10R4A-48	DC12V/24V	≤160	-40°C — +75°C	4pcs	1-4HZ	65	1214	11.2	● ● ● ○	Not available
TBD-10R5B-48	DC12V/24V	≤160	-40°C — +75°C	5pcs	1-4HZ	65	1214	14	● ● ● ○	Not available

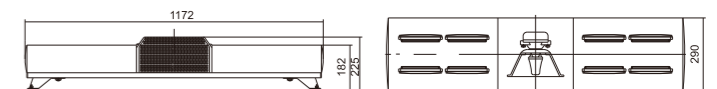

TBD-3000 Series Lightbar

Model	Rated Voltage (V)	Power (w)	Ambient temperature	LED	Flash settings	IP	Length(mm)	Net weight(kg)	Color	Speaker
TBD-30L14A-46	DC12V/24V	≤40W	-40°C — +75°C	14pcs	1-4HZ	65	1172	16.6	● ● ● ○	Available

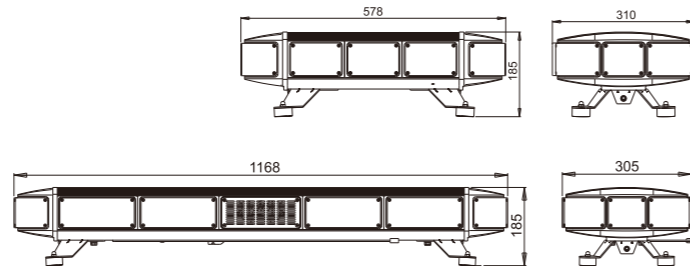
TBD-50L10-23

TBD-50L12A-48

TBD-5000 Series Lightbar

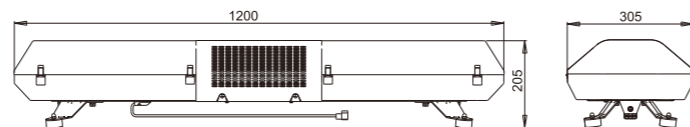
Model	Rated Voltage (V)	Power (w)	Ambient temperature	LED	Flash settings	IP	Length(mm)	Net weight(kg)	Color	Speaker
TBD-50L10-23	DC12V/24V	≤40W	-40°C — +75°C	10pcs	1-4HZ	65	578	10	● ● ● ○	Available
TBD-50L12A-48	DC12V/24V	≤85W	-40°C — +75°C	12pcs	1-4HZ	65	1168	18	● ● ● ○	Available



TBD-7000 Series Lightbar

Model	Rated Voltage (V)	Power (w)	Ambient temperature	LED	Flash settings	IP	Length(mm)	Net weight(kg)	Color	Speaker
TBD-70L8A-48	DC12V/24V	≤60W	-40°C — +75°C	8pcs	1-4HZ	65	1200	18	● ● ● ○	Available
TBD-70L14A-48	DC12V/24V	≤40W	-40°C — +75°C	14pcs	1-4HZ	65	1200	18	● ● ● ○	Available

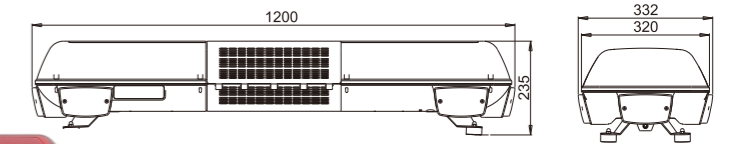

TBD-8000 Series Lightbar

Model	Rated Voltage (V)	Power (w)	Ambient temperature	LED	Flash settings	IP	Length(mm)	Net weight(kg)	Color	Speaker
TBD-80L8A-48	DC12V/24V	≤50W	-40°C — +75°C	8pcs	1-4HZ	65	1200	16	● ● ● ○	Available
TBD-80L18A-48	DC12V/24V	≤120W	-40°C — +75°C	18pcs	1-4HZ	65	1200	19	● ● ● ○	Available

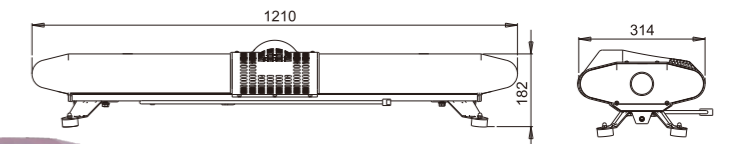
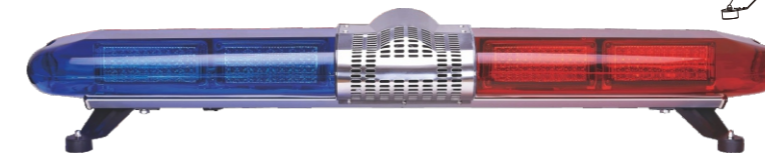

TBD-9000 Series Lightbar

Model	Rated Voltage (V)	Power (w)	Ambient temperature	LED	Flash settings	IP	Length(mm)	Net weight(kg)	Color	Speaker
TBD-90L8A-48	DC12V/24V	≤45W	-40°C — +75°C	8pcs	1-4HZ	65	1210	15	● ● ● ○	Available
TBD-90L12A-48	DC12V/24V	≤65W	-40°C — +75°C	12pcs	1-4HZ	65	1210	15.5	● ● ● ○	Available

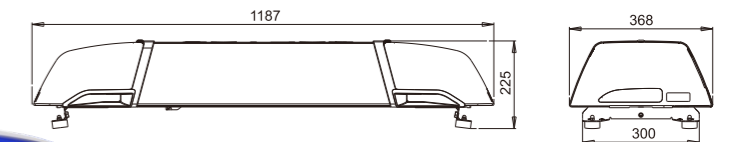
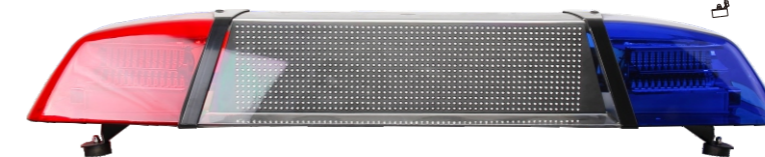

TBD-10000 Series Lightbar

Model	Rated Voltage (V)	Power (w)	Ambient temperature	LED	Flash settings	IP	Length(mm)	Net weight(kg)	Color	Speaker
TBD-100L4P-47	DC12V/24V	≤110W	-40°C — +75°C	4pcs	1-4HZ	65	1187	13.5	● ● ● ○	Available
TBD-100L4Y-47	DC12V/24V	≤140W	-40°C — +75°C	4pcs	1-4HZ	65	1187	13.5	● ● ● ○	Available



TBD-C000 Series Lightbar

Model	Rated Voltage (V)	Power (w)	Ambient temperature	LED	Flash settings	IP	Length(mm)	Net weight(kg)	Color	Speaker
TBD-COL12A-48	DC12V/24V	≤40W	-40°C — +75°C	12pcs	1-4HZ	65	1178	24	● ● ● ● ○	Available



TBD-T000 Series Lightbar

Model	Rated Voltage (V)	Power (w)	Ambient temperature	LED	Flash settings	IP	Length(mm)	Net weight(kg)	Color	Speaker
TBD-TOL12A-46	DC12V/24	≤45W	-40°C — +75°C	12pcs	1-4HZ	65	1200	12	● ● ● ● ○	Available



TBD-T000 Series Lightbar

Model	Rated Voltage (V)	Power (w)	Ambient temperature	LED	Flash settings	IP	Length(mm)
TBD-TOL12S-48	DC12V/24	≤25W	-40°C — +75°C	12pcs	1-4HZ	65	1200
Net weight(kg)	Color	Speaker	Solar battery (w)	Lithium battery specifications	Charging time(h)	Discharge time(h)	
20	● ● ● ● ○	Available	20	DC12V10Ah	10~15	≥15	

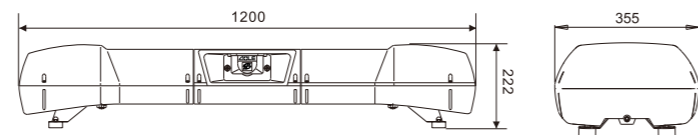

TBD-G000 Series Lightbar

Model	Rated Voltage (V)	Power (w)	Ambient temperature	LED	Flash settings	IP	Length(mm)	Net weight(kg)	Color	Speaker
TBD-GOL8A-48	DC12V/24V	≤50W	-40°C — +75°C	8pcs	1-4HZ	65	1200	18	● ● ● ● ○	Available
TBD-GOL8A-60	DC12V/24V	≤50W	-40°C — +75°C	8pcs	1-4HZ	65	1650	20	● ● ● ● ○	Available
TBD-GOL12A-48	DC12V/24V	≤80W	-40°C — +75°C	12pcs	1-4HZ	65	1200	19	● ● ● ● ○	Available



TBD-V000 Series Lightbar

Model	Rated Voltage (V)	Power (w)	Ambient temperature	LED	Flash settings	IP	Length(mm)	Net weight(kg)	Color	Speaker
TBD-VOL7A-46	DC12V/24V	≤80W	-40°C — +75°C	7pcs	1-4HZ	65	1166	15	● ● ● ● ○	Available



TBD-3H000 Series Lightbar

Model	Rated Voltage (V)	Power (w)	Ambient temperature	LED	Flash settings	IP	Length(mm)	Net weight(kg)	Color	Speaker
TBD-3H000	DC12V/24	≤40W	-40°C —+75°C	14pcs	1-4HZ	65	1200	12	● ● ● ● ○	Available



TBD-5H000 Series Lightbar

Model	Rated Voltage (V)	Power (w)	Ambient temperature	LED	Flash settings	IP	Length(mm)	Net weight(kg)	Color	Speaker
TBD-5H000	DC12V/24	≤40W	-40°C —+75°C	8pcs	1-4HZ	65	1200	15	● ● ● ● ○	Not Available



TBD-H000 Series Lightbar

Model	Rated Voltage (V)	Power (w)	Ambient temperature	LED	Flash settings	IP	Length(mm)	Net weight(kg)	Color	Speaker
TBD-2H000	DC12V/24	≤120W	-40°C —+75°C	12pcs	1-4HZ	65	1200	12	● ● ● ● ○	Available

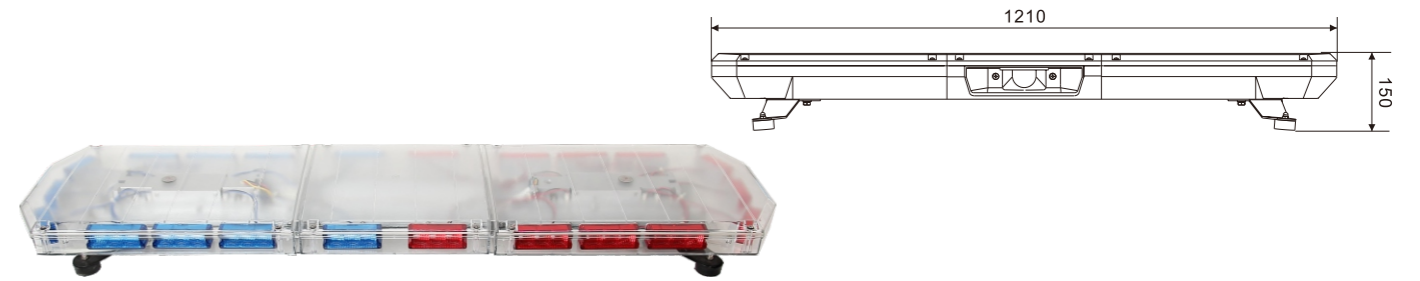

TBD-F000 Series Lightbar

Model	Rated Voltage (V)	Power (w)	Ambient temperature	LED	Flash settings	IP	Length(mm)	Net weight(kg)	Color	Speaker
TBD-F0W22B-48	DC12V/24V	≤120W	-40°C —+75°C	22pcs	1-4HZ	65	1210	13.3	● ● ● ● ○	Not available

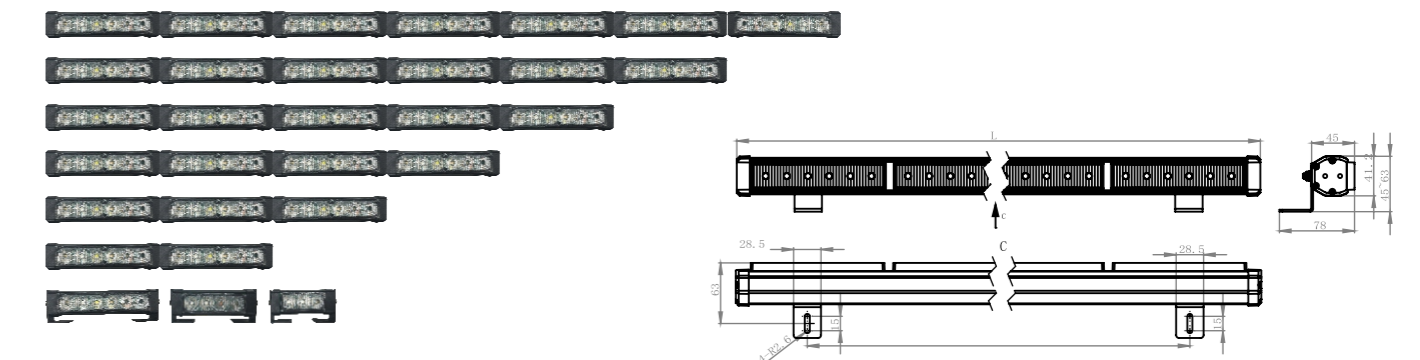

TBD-E000 Series Lightbar

Model	Rated Voltage (V)	Power (w)	Ambient temperature	LED	Flash settings	IP	Length(mm)	Net weight(kg)	Color	Speaker
TBD-E0H6C	DC12V/24V	≤54W	-40°C —+75°C	6*6pcs	1-4HZ	65	910	3	● ● ● ● ○	Not available

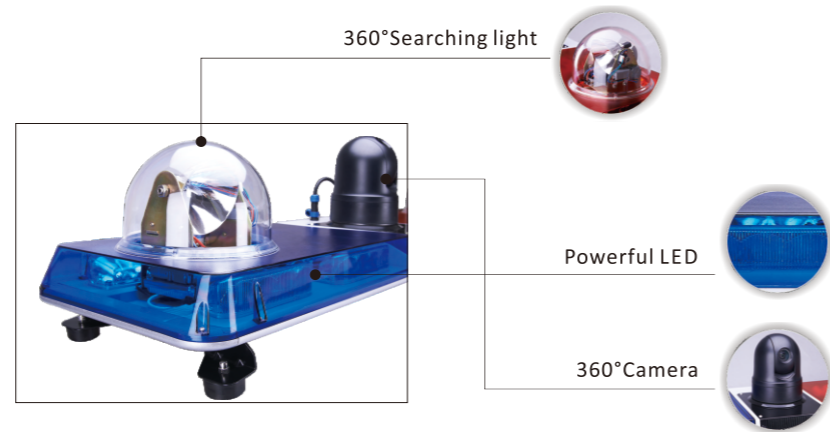
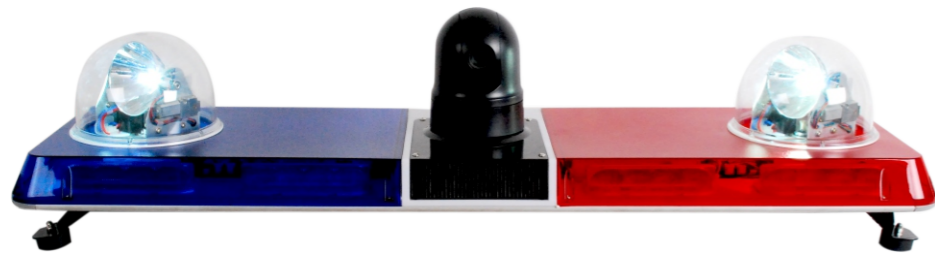

1. Warning light

Rated Voltage: DC12V/24V
Power: ≤40W
LED: 8
Frequency: 1Hz~ 3Hz
Color: Red/Blue/Amber
weight≥16Kg

2. Siren

Rated Voltage: DC12V/24V
Rated power: 100W
Frequency: 1Hz~ 3Hz
SPL: 110dB~120Db
Ambient temperature:40-55
Dimensions: 130mm*140mm*38mm

4. Camera

Rated Voltage: DC12V/24V
Rated power: 15W
Horizontal resolution: 480
Rotation speed: Horizontal plane 0.05°~ 300°/s; Vertical 0.05°~ 60°/s
Rotation angle: Horizontal plane 0°~ 360°Rotating; Vertical-15°~ 90°
IP: 66
Weight: 1Kg

3. Searching light

Rated Voltage: DC12V/24V
Light: HID
Light intensity: 200000cd
Rotation angle: Horizontal plane 0°~ 360°continuous rotate;
Vertical upward60°downward 15°
Rotation speed: Horizontal plane 30°~38°/s; Vertical 30°~38°/s

5. Display screen

Rated Voltage: DC12V/24V
Power:≤500W
LED distance: P10
Display angle : Horizontal plane 120°, Vertical 60°
Screen resolution : 10000/m²
Light intensity:≥2000cd/m²
Display size: available
Working time:>100 thousand hour

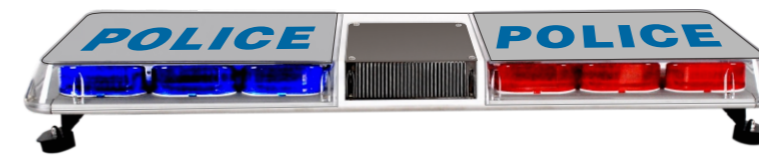
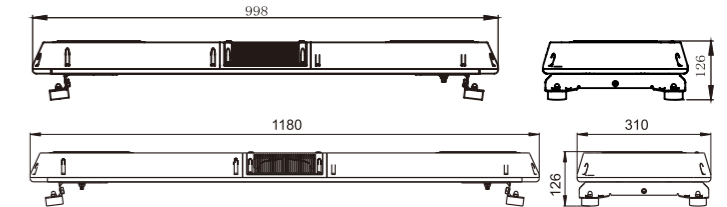

TBD-K000 Series Lightbar

Model	Rated Voltage (V)	Power (w)	Ambient temperature	LED	Flash settings	IP	Length(mm)	Net weight(kg)	Color	Speaker
TBD-K0W12A-47	DC12V/24V	≤48W	-40°C —+75°C	12pcs	1-4HZ	65	1180	12	● ● ● ○	Available
TBD-K0W8A-40	DC12V/24V	≤40W	-40°C —+75°C	8pcs	1-4HZ	65	998	12	● ● ● ○	Available

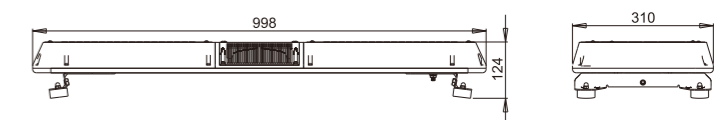

TBD-K000 Series Lightbar

Model	Rated Voltage (V)	Power (w)	Ambient temperature	LED	Flash settings	IP	Length(mm)
TBD-K0W8S-40	DC12	≤20	-40°C —+75°C	8	1-4HZ	65	998
TBD-K0W12S-40	DC12	≤16	-40°C —+75°C	12	1-4HZ	65	998
Net weight(kg)	Color	Speaker	Solar battery (w)	Lithium battery specifications	Charging time(h)	Discharge time(h)	
12	● ● ● ○	Available	20	DC12V10Ah	10~15	≥15	
12	● ● ● ○	Available	20	DC12V10Ah	10~15	≥15	

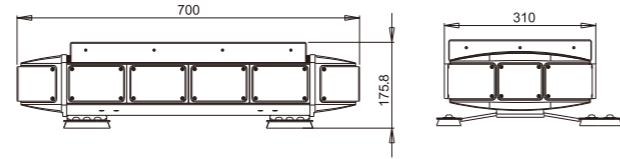

TBD-50L8SC Mini Lightbar

Model	Rated Voltage (V)	Power (w)	Ambient temperature	LED	Flash settings	IP	Length(mm)
TBD-50L8SC-28	DC12V	≤15W	-40°C ~ +75°C	8pcs	1-4HZ	65	700
Net weight(kg)	Color	Speaker	Solar battery (w)	Lithium battery specifications	Charging time(h)	Discharge time(h)	
11	● ● ● ● ○	Not available	20	DC12V20Ah	10~20	≥20	

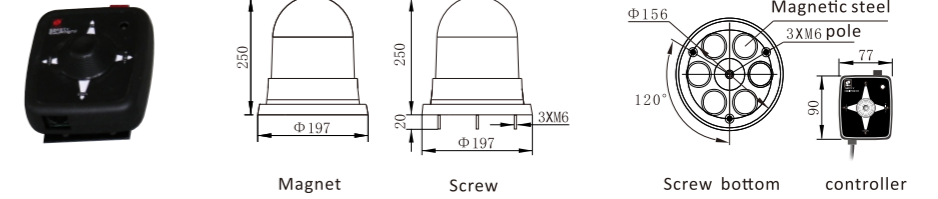

QSD-150H 360° Searching light

Model	Rated Voltage (V)	Power (w)	Rotation angle			Dimension	Net weight(kg)
			Horizontal plane	Degree up	Degree down		
QSD-150H	DC12/DC24	35W	360°	90°	30°	Φ197X250 Magnet Φ197X270 Screw	3.2

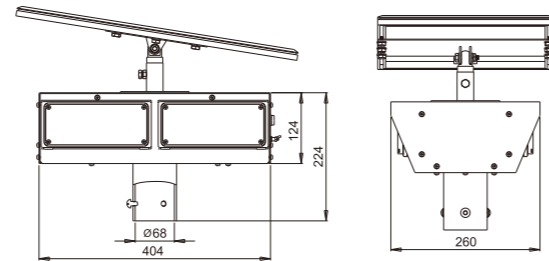

TBD-S2L4B Mini Lightbar

Model	Rated Voltage (V)	Power (w)	Ambient temperature	LED	Flash settings	IP	Length(mm)
TBD-S2L4B	DC12V	≤10W	-40°C ~ +75°C	4pcs	1-4HZ	65	404
Net weight(kg)	Color	Speaker	Solar battery (w)	Lithium battery specifications	Charging time(h)	Discharge time(h)	
8	● ● ● ● ○	Not available	15	DC12V20Ah	10~20	≥20	

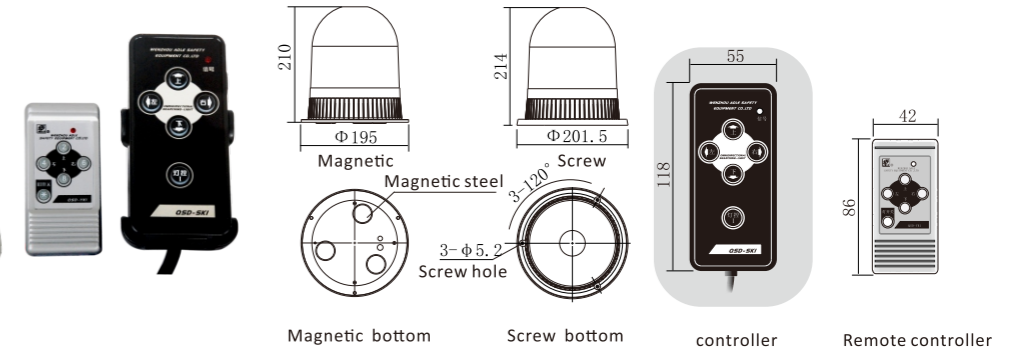

QSD-160 360° Searching light

Model	Rated Voltage (V)	Power (w)	Rotation angle			Dimension	Net weight(kg)
			Horizontal plane	Degree up	Degree down		
QSD-160	DC12/DC24	35W	360°	45°	12°	Φ201.5X214 Screw	3.2

BEACON SERIES



AL-S-09



AL-S-07



AL-S-08

Beacon AL-S

Model	AL-S-07	AL-S-08	AL-S-09
Rated Power (w)	≤4	≤6	≤6
Light Source	LED	LED	LED
Pattern	Flash	Flash	Flash
Color	Clear	Clear	Clear

Beacon TBD-5

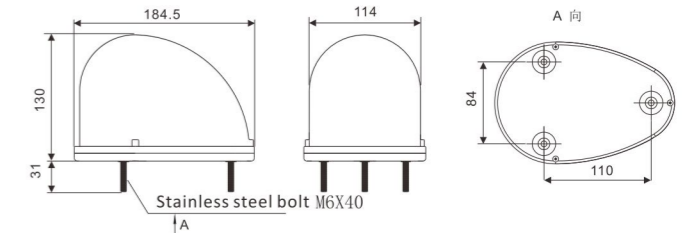

Model	TBD-5L	TBD-5LC
Rated Voltage (V)	DC12/DC24	DC12/DC24
Rated Power (w)	≤10	≤10
Ambient temperature	-40°C — +75°C	-40°C — +75°C
Light Source	LED	LED
Pattern	Flash	Flash
IP	67	67
Flash settings	1-4HZ	1-4HZ
Color	Red,Blue, Amber ,Green or Clear	Red,Blue, Amber ,Green or Clear
Dimensions(mm)	184.5*130*114	184.5*130*114
Net weight(kg)	0.52	0.52
Mounting	Screw	Magnetic





Beacon TBD-11

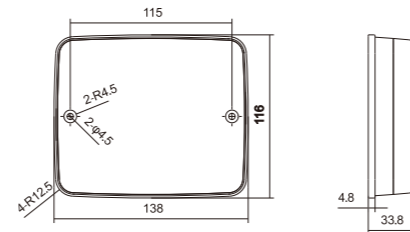

Model	TBD-11L
Rated Voltage (V)	DC12/DC24
Rated Power (w)	≤10
Ambient temperature	-40°C — +75°C
Light Source	LED
Pattern	Flash/Steady
IP	67
Flash settings	1-4HZ
Color	Red, Blue, Amber, Green or Clear
Dimensions(mm)	138*33.8*116
Net weight(kg)	0.11
Mounting	Screw

Beacon TBD-13

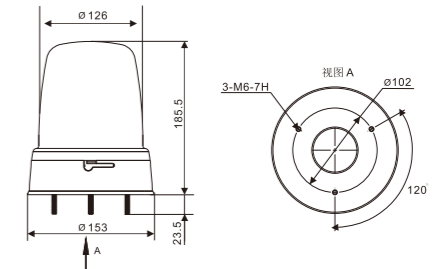

Model	TBD-13L	TBD-13LC
Rated Voltage (V)	DC12/DC24	DC12/DC24
Rated Power (w)	≤20	≤20
Ambient temperature	-40°C — +75°C	-40°C — +75°C
Light Source	LED	LED
Pattern	Flash	Flash
IP	67	67
Flash settings	1-4HZ	1-4HZ
Color	Red, Blue, Amber, Green or Clear	Red, Blue, Amber, Green or Clear
Dimensions(mm)	185.5*153*153	185.5*153*153
Net weight(kg)	0.7	0.7
Mounting	Screw	Magnetic

Beacon TBD-12

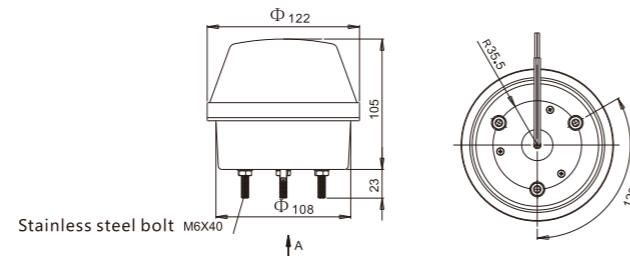

Model	TBD-12L	TBD-12LC
Rated Voltage (V)	DC12/DC24	DC12/DC24
Rated Power (w)	≤10	≤10
Ambient temperature	-40°C — +75°C	-40°C — +75°C
Light Source	LED	LED
Pattern	Flash	Flash
IP	67	67
Flash settings	1-4HZ	1-4HZ
Color	Red, Blue, Amber, Green or Clear	Red, Blue, Amber, Green or Clear
Dimensions(mm)	122*122*105	122*122*105
Net weight(kg)	0.3	0.3
Mounting	Screw	Magnetic

Beacon TBD-15

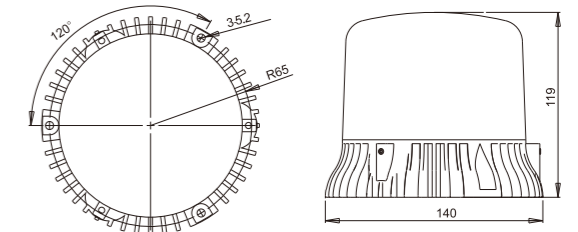

Model	TBD-15W	TBD-15WC
Rated Voltage (V)	DC12/DC24	DC12/DC24
Rated Power (w)	≤60	≤60
Ambient temperature	-40°C — +75°C	-40°C — +75°C
Light Source	LED	LED
Pattern	Flash	Flash
IP	67	67
Flash settings	1-4HZ	1-4HZ
Color	Red, Blue, Amber, Green or Clear	Red, Blue, Amber, Green or Clear
Dimensions(mm)	140*140*119	140*140*119
Net weight(kg)	0.45	0.45
Mounting	Screw	Magnetic



Beacon TBD-16

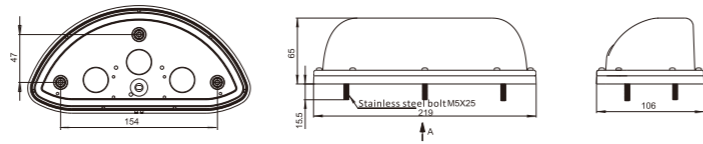

Model	TBD-16W	TBD-16WC
Rated Voltage (V)	DC12/DC24	DC12/DC24
Rated Power (w)	≤16	≤16
Ambient temperature	-40°C — +75°C	-40°C — +75°C
Light Source	LED	LED
Pattern	Flash	Flash
IP	67	67
Flash settings	1-4HZ	1-4HZ
Color	Red,Blue, Amber ,Green or Clear	Red,Blue, Amber ,Green or Clear
Dimensions(mm)	219*65*106	219*65*106
Net weight(kg)	0.55	0.55
Mounting	Screw	Magnetic

Beacon TBD-18

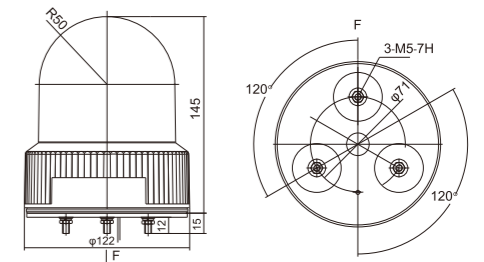

Model	TBD-18L	TBD-18LC
Rated Voltage (V)	DC12/DC24	DC12/DC24
Rated Power (w)	≤10	≤10
Ambient temperature	-40°C — +75°C	-40°C — +75°C
Light Source	LED	LED
Pattern	Flash	Flash
IP	67	67
Flash settings	1-4HZ	1-4HZ
Color	Red,Blue, Amber ,Green or Clear	Red,Blue, Amber ,Green or Clear
Dimensions(mm)	122*122*145	122*122*145
Net weight(kg)	0.47	0.47
Mounting	Screw	Magnetic

Beacon TBD-17

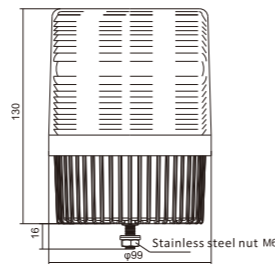

Model	TBD-17L	TBD-17LC
Rated Voltage (V)	DC12/DC24	DC12/DC24
Rated Power (w)	≤10	≤10
Ambient temperature	-40°C — +75°C	-40°C — +75°C
Light Source	LED	LED
Pattern	Flash	Flash
IP	67	67
Flash settings	1-4HZ	1-4HZ
Color	Red,Blue, Amber ,Green or Clear	Red,Blue, Amber ,Green or Clear
Dimensions(mm)	130*99*99	130*99*99
Net weight(kg)	1.1	1.1
Mounting	Screw	Magnetic

Beacon TBD-20

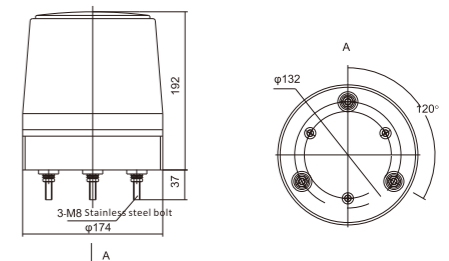

Model	TBD-20L	TBD-20LC
Rated Voltage (V)	DC12/DC24	DC12/DC24
Rated Power (w)	≤10	≤10
Ambient temperature	-40°C — +75°C	-40°C — +75°C
Light Source	LED	LED
Pattern	Flash	Flash
IP	67	67
Flash settings	1-4HZ	1-4HZ
Color	Red,Blue, Amber ,Green or Clear	Red,Blue, Amber ,Green or Clear
Dimensions(mm)	174*174*192	174*174*192
Net weight(kg)	1.12	1.12
Mounting	Screw	Magnetic



Beacon TBD-21

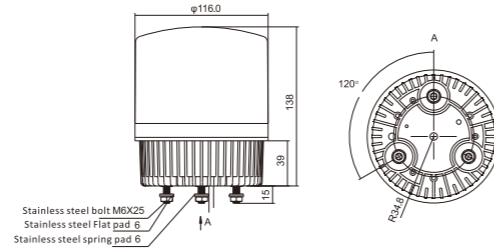

Model	TBD-21L	TBD-21LC
Rated Voltage (V)	DC12/DC24	DC12/DC24
Rated Power (w)	≤10	≤10
Ambient temperature	-40°C — +75°C	-40°C — +75°C
Light Source	LED	LED
Pattern	Flash	Flash
IP	67	67
Flash settings	1-4HZ	1-4HZ
Color	Red,Blue, Amber ,Green or Clear	Red,Blue, Amber ,Green or Clear
Dimensions(mm)	116*116*138	116*116*138
Net weight(kg)	0.53	0.53
Mounting	Screw	Magnetic

Beacon TBD-22

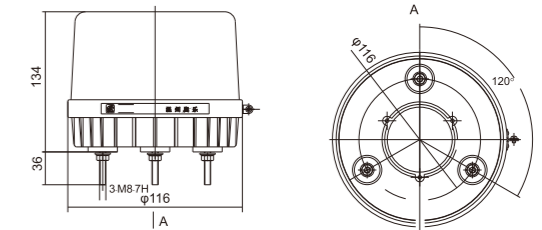

Model	TBD-22L	TBD-22LC
Rated Voltage (V)	DC12/DC24	DC12/DC24
Rated Power (w)	≤10	≤10
Ambient temperature	-40°C — +75°C	-40°C — +75°C
Light Source	LED	LED
Pattern	Flash	Flash
IP	67	67
Flash settings	1-4HZ	1-4HZ
Color	Red,Blue, Amber ,Green or Clear	Red,Blue, Amber ,Green or Clear
Dimensions(mm)	116*116*134	116*116*134
Net weight(kg)	0.78	0.78
Mounting	Screw	Magnetic

Beacon TBD-21LC

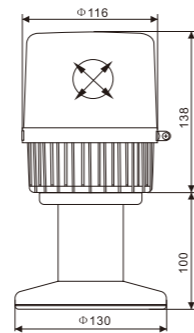

Model	TBD-21LC
Rated Voltage (V)	DC12/DC24
Rated Power (w)	≤10
Ambient temperature	-40°C — +75°C
Light Source	LED
Pattern	Flash
IP	67
Flash settings	1-4HZ
Color	Red,Blue, Amber ,Green or Clear
Dimensions(mm)	130*130*238
Net weight(kg)	0.57
Mounting	Magnetic

Beacon TBD-23

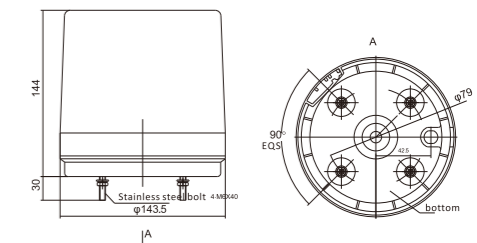

Model	TBD-23L	TBD-23LC
Rated Voltage (V)	DC12/DC24	DC12/DC24
Rated Power (w)	≤10	≤10
Ambient temperature	-40°C — +75°C	-40°C — +75°C
Light Source	LED	LED
Pattern	Flash	Flash
IP	67	67
Flash settings	1-4HZ	1-4HZ
Color	Red,Blue, Amber ,Green or Clear	Red,Blue, Amber ,Green or Clear
Dimensions(mm)	143.5*143.5*114	143.5*143.5*114
Net weight(kg)	1.055	1.055
Mounting	Screw	Magnetic



Beacon TBD-24

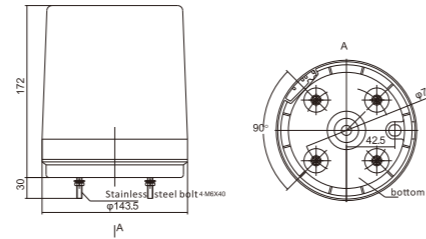

Model	TBD-24L	TBD-24LC
Rated Voltage (V)	DC12/DC24	DC12/DC24
Rated Power (w)	≤10	≤10
Ambient temperature	-40°C — +75°C	-40°C — +75°C
Light Source	LED	LED
Pattern	Flash	Flash
IP	67	67
Flash settings	1-4HZ	1-4HZ
Color	Red,Blue, Amber ,Green or Clear	Red,Blue, Amber ,Green or Clear
Dimensions(mm)	143.5*143.5*172	143.5*143.5*172
Net weight(kg)	1.09	1.09
Mounting	Screw	Magnetic

Beacon TBD-26

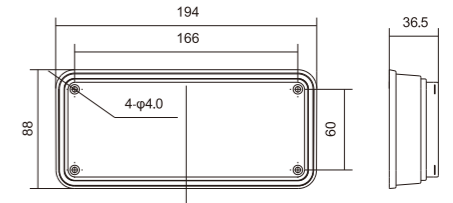

Model	TBD-26L
Rated Voltage (V)	DC12/DC24
Rated Power (w)	≤10
Ambient temperature	-40°C — +75°C
Light Source	LED
Pattern	Flash/Steady
IP	67
Flash settings	1-4HZ
Color	Red,Blue, Amber ,Green or Clear
Dimensions(mm)	194*88*36.5
Net weight(kg)	0.19
Mounting	Screw

Beacon TBD-25

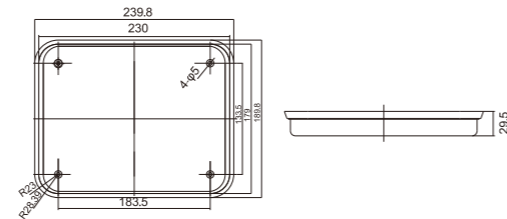

Model	TBD-25L
Rated Voltage (V)	DC12/DC24
Rated Power (w)	≤12
Ambient temperature	-40°C — +75°C
Light Source	LED
Pattern	Flash/Steady
IP	67
Flash settings	1-4HZ
Color	Red,Blue, Amber ,Green or Clear
Dimensions(mm)	239.8*29.5*189.8
Net weight(kg)	0.36
Mounting	Screw

Beacon TBD-27

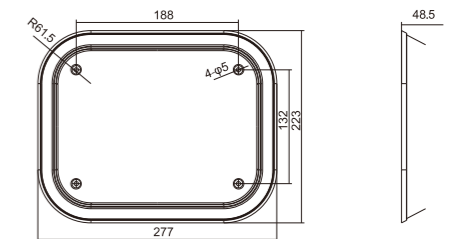

Model	TBD-27L
Rated Voltage (V)	DC12/DC24
Rated Power (w)	≤12
Ambient temperature	-40°C — +75°C
Light Source	LED
Pattern	Flash/Steady
IP	67
Flash settings	1-4HZ
Color	Red,Blue, Amber ,Green or Clear
Dimensions(mm)	277*223*48.5
Net weight(kg)	0.7
Mounting	Screw



Beacon TBD-28

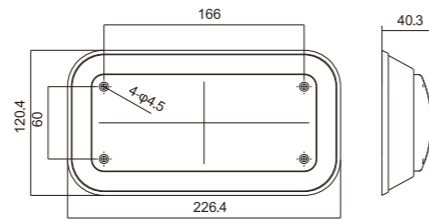

Model	TBD-28L
Rated Voltage (V)	DC12/DC24
Rated Power (w)	≤10
Ambient temperature	-40°C — +75°C
Light Source	LED
Pattern	Flash/Steady
IP	67
Flash settings	1-4HZ
Color	Red, Blue, Amber, Green or Clear
Dimensions(mm)	226.4*120.4*40.3
Net weight(kg)	0.325
Mounting	Screw

Beacon TBD-30-A

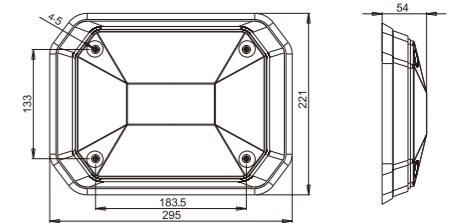

Model	TBD-30-A
Rated Voltage (V)	DC12/DC24
Rated Power (w)	≤36
Ambient temperature	-40°C — +75°C
Light Source	LED
Pattern	Flash/Steady
IP	67
Flash settings	1-4HZ
Color	Red, Blue, Amber, Green or Clear
Dimensions(mm)	295*221*54
Net weight(kg)	0.7
Mounting	Screw

Beacon TBD-29

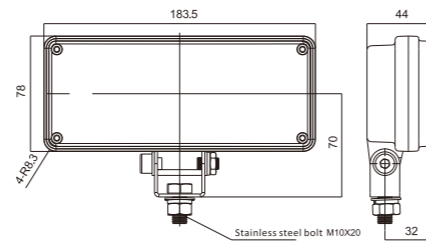

Model	TBD-29L
Rated Voltage (V)	DC12/DC24
Rated Power (w)	≤15
Ambient temperature	-40°C — +75°C
Light Source	LED
Pattern	Steady
IP	67
Flash settings	1-4HZ
Color	Clear
Dimensions(mm)	183.5*78*44
Net weight(kg)	0.5
Mounting	Screw

Beacon TBD-30-B

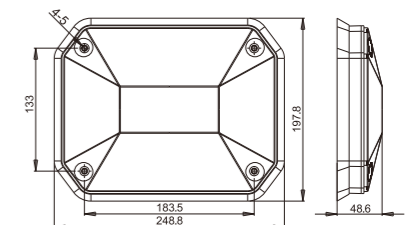
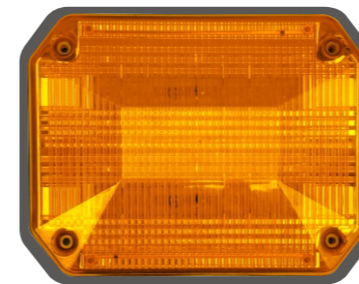

Model	TBD-30-B
Rated Voltage (V)	DC12/DC24
Rated Power (w)	≤36
Ambient temperature	-40°C — +75°C
Light Source	LED
Pattern	Flash/Steady
IP	67
Flash settings	1-4HZ
Color	Red, Blue, Amber, Green or Clear
Dimensions(mm)	248.8*197.8*48.6
Net weight(kg)	0.65
Mounting	Screw



Beacon TBD-31



TBD-31-3

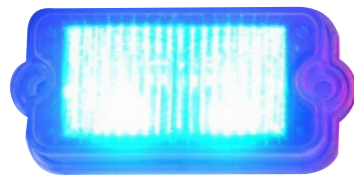

TBD-31-2

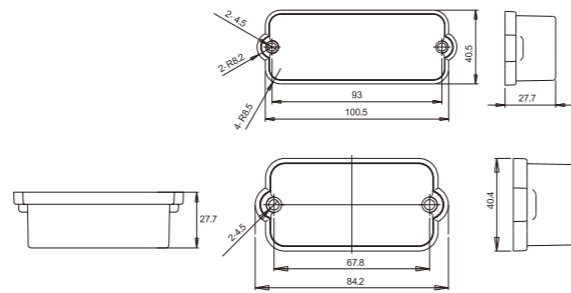

Model	TBD-31-2	TBD-31-3
Rated Voltage (V)	DC12/DC24	DC12/DC24
Rated Power (w)	≤6	≤6
Ambient temperature	-40°C — +75°C	-40°C — +75°C
Light Source	LED	LED
Pattern	Flash	Flash
IP	67	67
Flash settings	1-4HZ	1-4HZ
Color	Red,Blue, Amber ,Green or Clear	Red,Blue, Amber ,Green or Clear
Dimensions(mm)	84.2*40.4*27.7	100.5*40.5*27.7
Net weight(kg)	0.4	0.4
Mounting	Screw	Screw

Beacon TBD-33

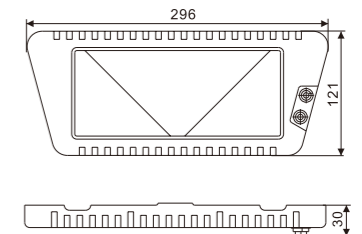
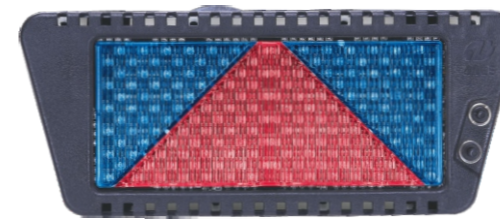

Model	TBD-33
Rated Voltage (V)	DC12/DC24
Rated Power (w)	≤10
Ambient temperature	-40°C — +75°C
Light Source	LED
Pattern	Flash
IP	67
Flash settings	1-4HZ
Color	Red,Blue, Amber ,Green or Clear
Dimensions(mm)	296*121*30
Net weight(kg)	0.46
Mounting	velcro

Beacon TBD-32W

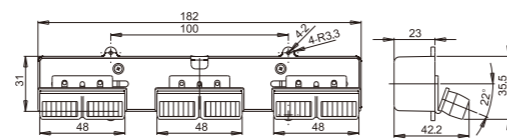

Model	TBD-32W
Rated Voltage (V)	DC12/DC24
Rated Power (w)	≤15
Ambient temperature	-40°C — +75°C
Light Source	LED
Pattern	Flash
IP	67
Flash settings	1-4HZ
Color	Red or Blue
Dimensions(mm)	182*31*23
Net weight(kg)	0.396
Mounting	Screw

Beacon TBD-35

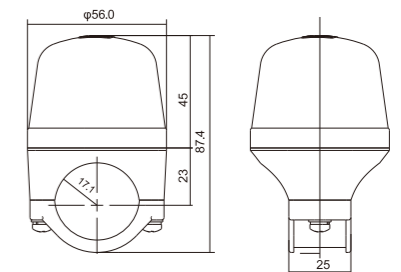

Model	TBD-35
Rated Voltage (V)	DC12/DC24
Rated Power (w)	≤5
Ambient temperature	-40°C — +75°C
Light Source	LED
Pattern	Flash
IP	67
Flash settings	1-4HZ
Color	Red
Dimensions(mm)	56*56*87.4
Net weight(kg)	0.15
Mounting	Screw



Beacon TBD-36

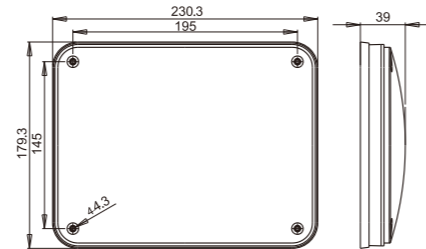
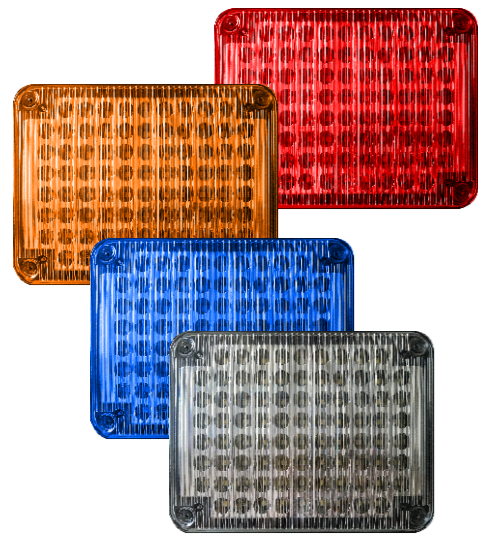

Model	TBD-36L
Rated Voltage (V)	DC12/DC24
Rated Power (w)	≤25
Ambient temperature	-40°C — +75°C
Light Source	LED
Pattern	Flash/Steady
IP	67
Flash settings	1-4HZ
Color	Red,Blue, Amber ,Green or Clear
Dimensions(mm)	230.3*179.3*39
Net weight(kg)	0.36
Mounting	Screw

Beacon TBD-38

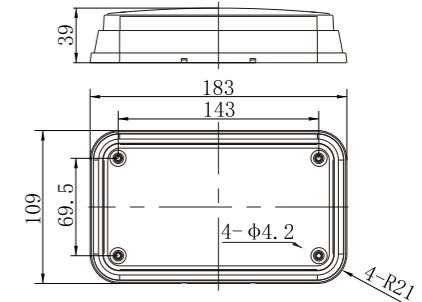

Model	TBD-38	TBD-38T
Rated Voltage (V)	DC12/DC24	DC9/DC32
Rated Power (w)	≤12	≤12
Ambient temperature	-40°C — +75°C	-40°C — +75°C
Light Source	LED	LED
Pattern	Steady	Steady
IP	67	67
Flash settings	1-3HZ	1-3HZ
Color	Red,Blue, Amber ,Green or Clear	Red,Blue, Amber ,Green or Clear
Dimensions(mm)	183*109*39	183*109*39
Net weight(kg)	0.29	0.29
Mounting	Screw	Screw

Beacon TBD-37

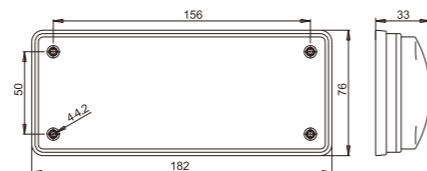
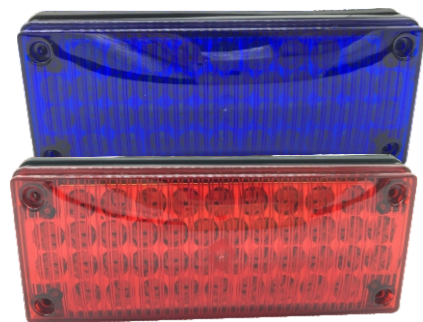

Model	TBD-37L
Rated Voltage (V)	DC12/DC24
Rated Power (w)	≤12
Ambient temperature	-40°C — +75°C
Light Source	LED
Pattern	Flash/Steady
IP	67
Flash settings	1-4HZ
Color	Red,Blue, Amber ,Green or Clear
Dimensions(mm)	182*76*33
Net weight(kg)	0.19
Mounting	Screw

Beacon TBD-41

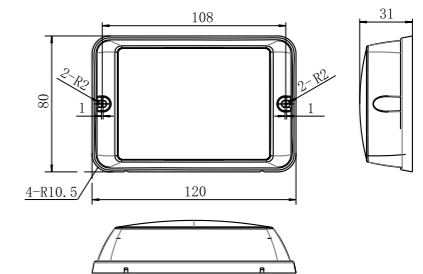

Model	TBD-41
Rated Voltage (V)	DC12/DC24
Rated Power (w)	≤18
Ambient temperature	-40°C — +75°C
Light Source	LED
Pattern	Flash/Steady
IP	66
Flash settings	1-4HZ
Color	Red,Blue, Amber ,Green or Clear
Dimensions(mm)	120*80*31
Net weight(kg)	0.315
Mounting	Screw



Beacon TBD-42



Front



back

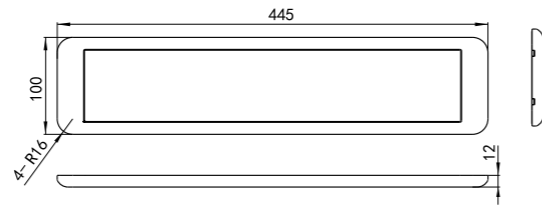

Model	TBD-42
Rated Voltage (V)	DC12/DC24
Rated Power (w)	≤15
Ambient temperature	-40°C — +75°C
Light Source	LED
Pattern	Steady
IP	67
Flash settings	1-4HZ
Color	White
Dimensions(mm)	445*100*12
Net weight(kg)	0.525
Mounting	Screw

Beacon TBD-42B



Front



back

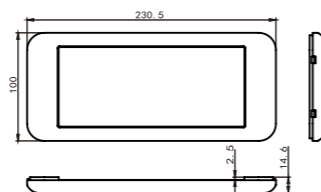

Model	TBD-42B
Rated Voltage (V)	DC12/DC24
Rated Power (w)	≤8
Ambient temperature	-40°C — +75°C
Light Source	LED
Pattern	Steady
IP	67
Flash settings	1-4HZ
Color	White
Dimensions(mm)	230.5*100*14.6
Net weight(kg)	1.5
Mounting	Screw

Beacon TBD-51

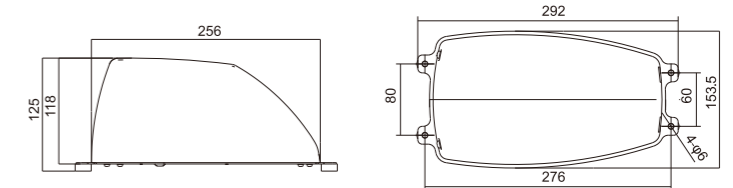

Model	TBD-51L	TBD-51W
Rated Voltage (V)	DC12/DC24	DC12/DC24
Rated Power (w)	≤10	≤16
Ambient temperature	-40°C — +75°C	-40°C — +75°C
Light Source	LED	LED
Pattern	Flash	Flash
IP	67	67
Flash settings	1-4HZ	1-4HZ
Color	Red, Blue, Amber, Green or Clear	Red, Blue, Amber, Green or Clear
Dimensions(mm)	256*118*153.5	256*118*153.5
Net weight(kg)	0.66	0.66
Mounting	Screw	Screw

Beacon TBD-53X

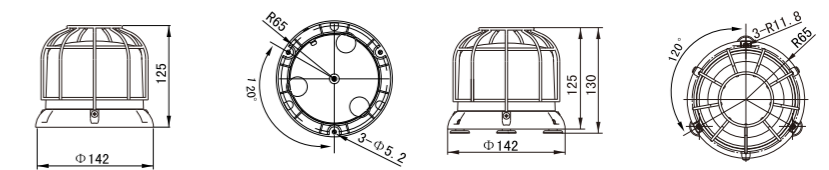

TBD-53X

TBD-53XC

Model	TBD-53X	TBD-53XC
Rated Voltage (V)	DC12/DC24	DC12/DC24
Rated Power (w)	≤12	≤12
Ambient temperature	-40°C — +75°C	-40°C — +75°C
Light Source	LED	LED
Pattern	rotating	rotating
IP	67	67
Flash settings	1-4HZ	1-4HZ
Color	Red, Blue, Amber, Green or Clear	Red, Blue, Amber, Green or Clear
Dimensions(mm)	142*142*125	154*154*130
Net weight(kg)	0.672	0.701
Mounting	Screw	Magnetic



Beacon TBD-53

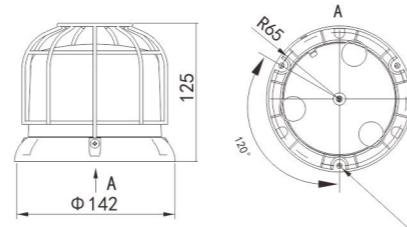

Model	TBD-53
Rated Voltage (V)	DC12/DC24
Rated Power (w)	≤20
Ambient temperature	-40°C — +75°C
Light Source	LED
Pattern	Flash
IP	67
Flash settings	1-3HZ
Color	Red,Blue, Amber ,Green or Clear
Dimensions(mm)	142*142*125
Net weight(kg)	0.8
Mounting	Screw or Magnetic

Beacon TBD-53

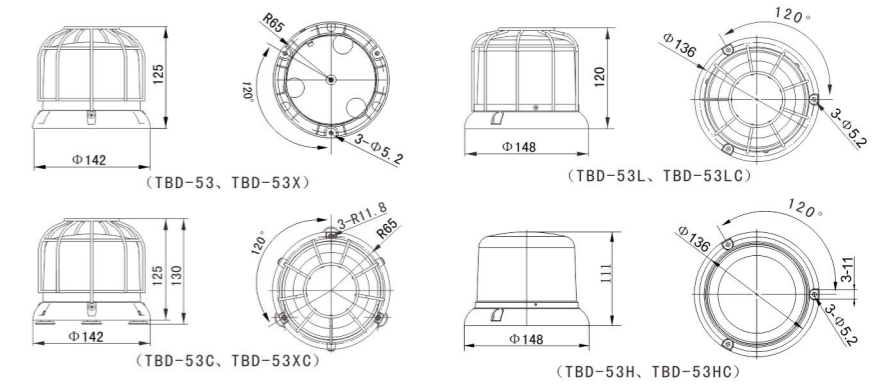

Model	TBD-53	TBD-53L	TBD-53H
	TBD-53C	TBD-53LC	TBD-53HC
Rated Voltage (V)	DC12/DC24	DC12/DC24	DC12/DC24
Rated Power (w)	≤20	≤20	≤18
Ambient temperature	-40°C — +75°C	-40°C — +75°C	-40°C — +75°C
Light Source	LED	LED	LED
Pattern	Flash	Flash	Flash
IP	67	67	67
Flash settings	1-4HZ	1-4HZ	1-4HZ
Color	Red,Blue, Amber ,Green or Clear		
Dimensions(mm)	142*142*125	148*148*120	148*148*111
	154*154*130	148*148*120	148*148*111
Net weight(kg)	0.672	0.454	0.340
	0.701	0.483	0.369
Mounting	Magnetic	Magnetic	Magnetic

Beacon TBD-55

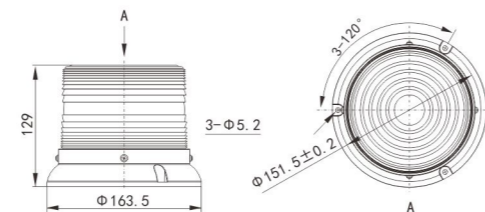

Model	TBD-55
Rated Voltage (V)	DC12/DC24
Rated Power (w)	≤18
Ambient temperature	-40°C — +75°C
Light Source	LED
Pattern	Flash
IP	67
Flash settings	1-4HZ
Color	Red,Blue, Amber ,Green or Clear
Dimensions(mm)	163.5*163.5*129
Net weight(kg)	0.48
Mounting	Screw

MOTO-LIGHT SERIES

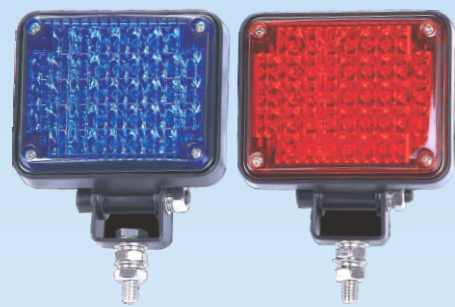

Moto-light TBD-3L

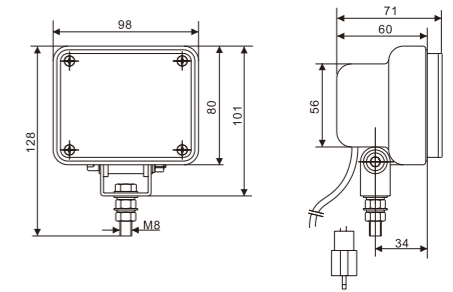

Model	TBD-3L
Rated Voltage (V)	DC12/DC24
Rated Power (w)	≤8
Ambient temperature	-40°C — +75°C
Light Source	LED
Pattern	Flash
IP	67
Flash settings	1-3HZ
Color	Red,Blue, Amber ,Green or Clear
Dimensions(mm)	98*128*71
Net weight(kg)	0.23
Mounting	Screw

Moto-light TBD-7W

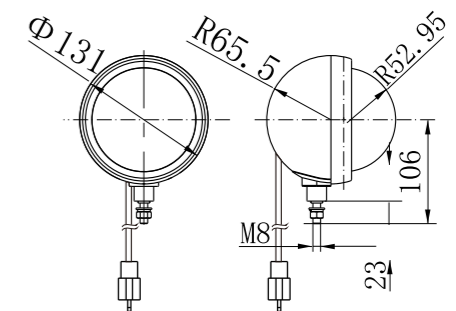

Model	TBD-7W
Rated Voltage (V)	DC12
Rated Power (w)	≤15
Ambient temperature	-40°C — +75°C
Light Source	LED
Pattern	Flash
IP	67
Flash settings	1-3HZ
Color	Red,Blue, Amber ,Green or Clear
Dimensions(mm)	130*130*160
Net weight(kg)	0.4
Mounting	Screw



Moto-light TBD-6BLG/TBD-8BLG

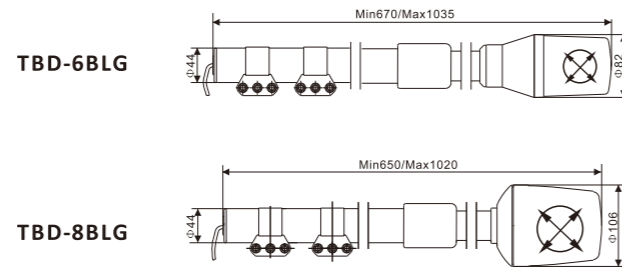

Model	TBD-6BLG	TBD-8BLG
Rated Voltage (V)	DC12/DC24	DC12/DC24
Rated Power (w)	≤16	≤16
Ambient temperature	-40°C — +75°C	-40°C — +75°C
Light Source	LED	LED
Pattern	Flash	Flash
IP	67	67
Flash settings	1-3HZ	1-3HZ
Color	Red,Blue, Amber ,Green or Clear	Red,Blue, Amber ,Green or Clear
Dimensions(mm)	Min670/Max1035*Φ44*Φ82	Min650/Max1020*Φ44*Φ106
Net weight(kg)	1.045	1.205
Mounting	Pole	Pole

Moto-light TBD-6BWG

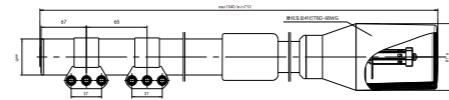

Model	TBD-6BWG
Rated Voltage (V)	DC9/DC32
Rated Power (w)	≤18
Ambient temperature	-40°C — +75°C
Light Source	LED
Pattern	Flash
IP	67
Flash settings	1-3HZ
Color	Red,Blue, Amber ,Red Blue
Dimensions(mm)	Min710/Max1040*Φ44*Φ81.6
Net weight(kg)	1.2
Mounting	Pole

Moto-light W12-03C

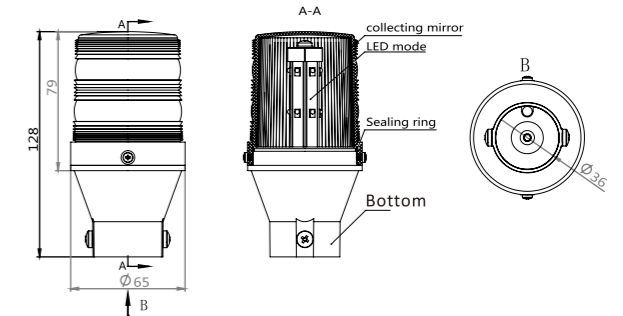

Model	W12-03C
Rated Voltage (V)	DC9/DC32
Rated Power (w)	≤25
Ambient temperature	-40°C — +75°C
Light Source	LED
Pattern	Flash/rotating/Steady
IP	67
Flash settings	1-3HZ
Color	Red,Blue, Amber ,Green or Clear
Dimensions(mm)	128*65*65
Net weight(kg)	0.18
Mounting	Pole

Moto-light MJB-20/MJB-40

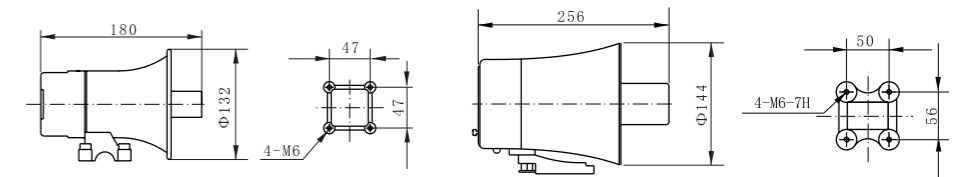

Model	MJB-20	MJB-40
Rated Voltage (V)	DC12(DC9V~DC16V)	DC12(DC9V~DC16V)
Rated Power (w)	≤20	≤40
Frequency	550-5000HZ	550-5000HZ
Ambient temperature	-40°C — +55°C	-40°C — +55°C
Impedance	8Ω	8Ω
SPL	110dB-115dB(A)	115~120dB
Dimensions(mm)	180*132*132	256*144*144
Net weight(kg)	0.812	1.4
Mounting	screw	screw

ARROW BOARD SERIES



Arrow Board JDX-1580

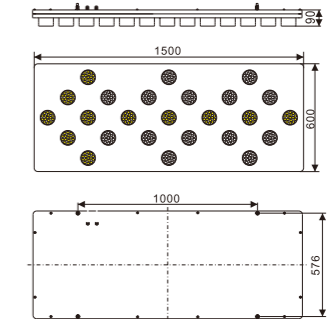
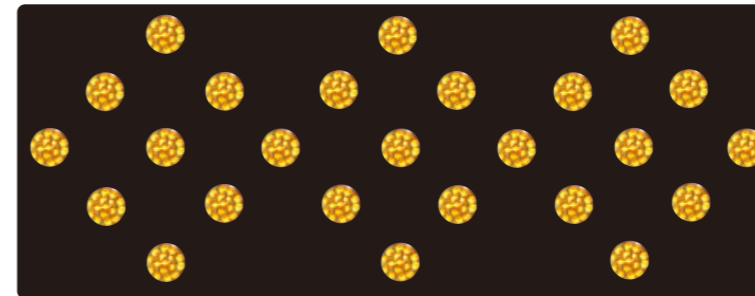

Model	JDX-1580-62
Rated Voltage (V)	DC12/DC24
Current	≤2A
Light Intensity	100~800cd
Flash Frequency	1~3Hz
Light Quantity	25Set
Dimension	1500X600X90mm
Weight	27.5kg
Base	steel plate
Controller	JDX-K4
Wire Length	6M
Light cover	PC

	first	Second	Third
Sequential chevron left mode			
Sequential chevron right mode			
Sequential stem arrow left mode			
Sequential stem arrow right mode			
Sequential head arrow left mode			
Sequential head arrow right mode			
Single flashing arrow left mode			
Single flashing arrow right mode			
Double flashing arrow right or left mode			
Caution Rect. mode			
Caution Bar mode			
Caution Alt Diamond mode			

Arrow Board JDX-1526

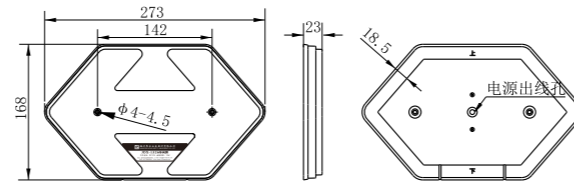

Model	JDX-1526
Rated Voltage (V)	DC12/24V
Current	≤1.5A
Light Intensity	100~800cd
Flash Frequency	1~3Hz
Light Source	LED
Rated Power (w)	≤18W
Dimensions(mm)	273X168X23
Net weight(kg)	≤0.5
Controller	JDX-K3
Wire Length	6M
Light cover	PC

The left and the right lights are controlled by two independent switches, and also can flash separately or simultaneously.

Arrow Board JDX-1890

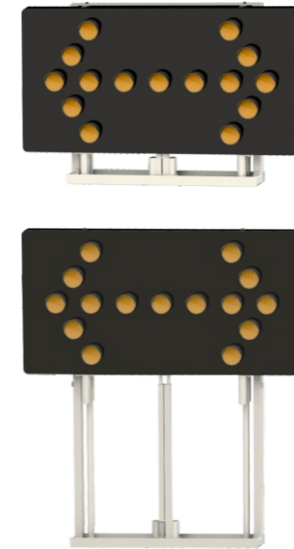

Model	JDX-1890
Rated Voltage (V)	DC12/24V
Flash Frequency	1~3Hz
Light Source	LED
Rated Power (w)	≤160W
Dimensions(mm)	1800X900X185.5

Arrow Board JDX-1526B

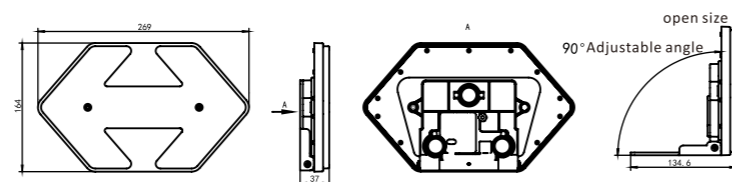

Model	JDX-1526B
Rated Voltage (V)	DC3.5/4.2V
Rated Power (w)	≤7W
Uninterrupted Working Time	More than 5 hours
flashing rate	70 flash / min (flash mode and flashing rate can be customized according to customer's requirement)
Charging current	≤2A
Charging time	≤4H
Color	Amber
Net weight(kg)	0.691
Dimensions(mm)	269*37*164
Mounting	magenetic



JDX-K3 Arrow board Controller



JDX-K2 Arrow board Controller

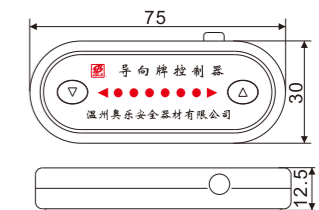

JDX-K2 Arrow board Controller

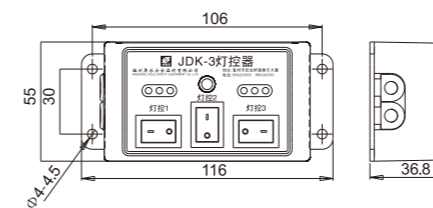

JDX-K3 Arrow board Controller



JDX-K4 Arrow board Controller

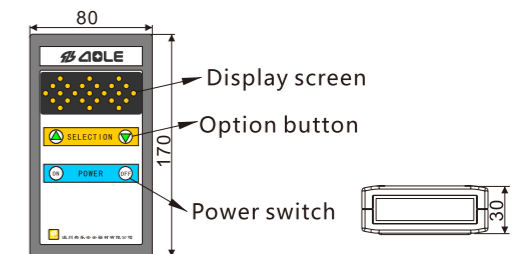

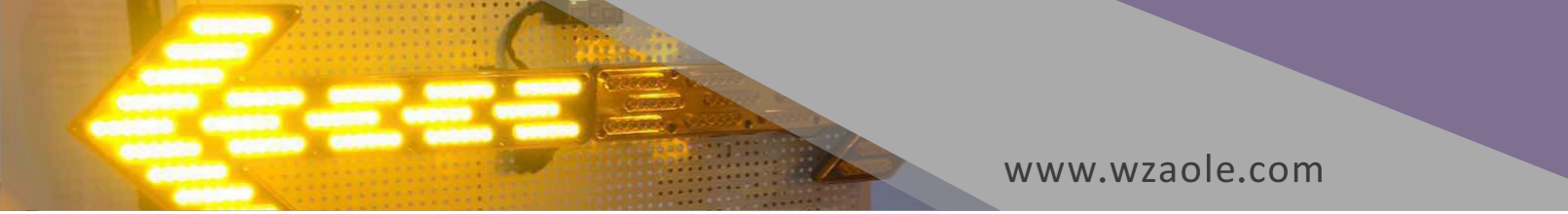

Arrow Board JDX-1588A

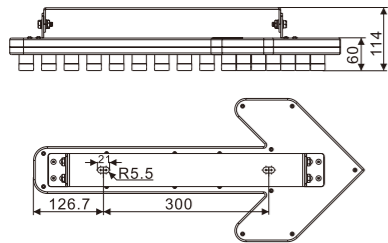
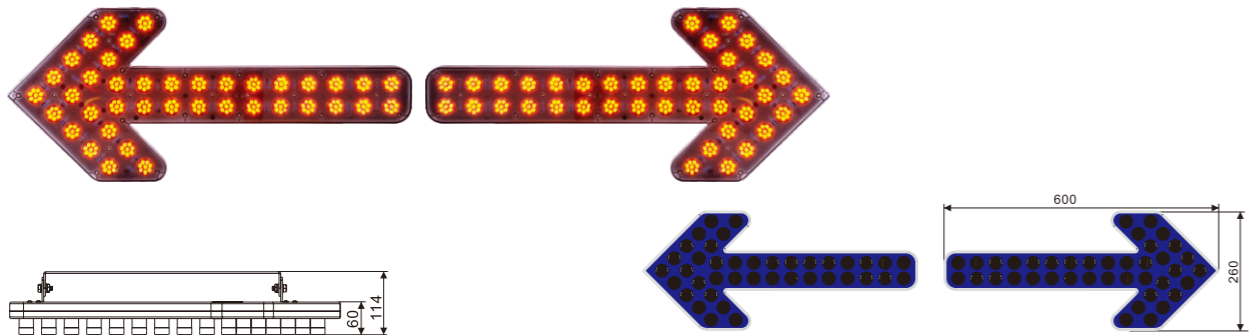

Model	JDX-1588A
Rated Voltage (V)	DC12/24V
Current	≤6A
Light Intensity	100~800cd
Flash Frequency	1~3Hz
Light Quantity	40sets×2
Dimension	600X260X60mm
Weight	6.94kg
Base	PC
Controller	JDX-K3
Wire Length	6M
Light cover	PC

The left and the right lights are controlled by two independent switches, and also can flash separately or simultaneously.

Arrow Board JDX-1586

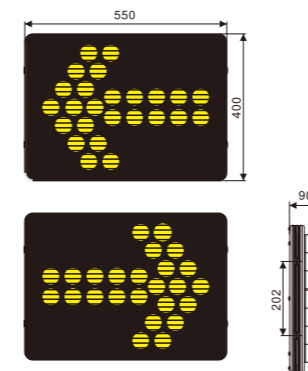
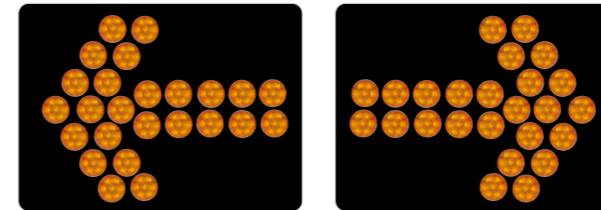

Model	JDX-1586-22
Rated Voltage (V)	DC12/24V
Current	≤3A
Light Intensity	100~800cd
Flash Frequency	1~3Hz
Light Quantity	25sets×2
Dimension	550X400X90mm
Weight	9.3kg
Base	Steel
Controller	JDX-K3
Wire Length	6M
Light cover	PC

The left and the right lights are controlled by two independent switches, and also can flash separately or simultaneously.

Arrow Board JDX-1585

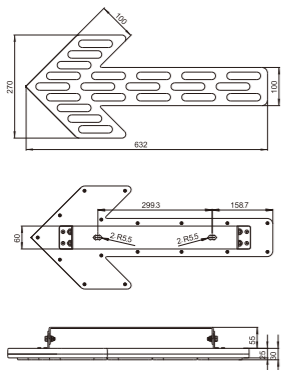

Model	JDX-1585
Rated Voltage (V)	DC12/24V
Current	≤6A
Light Intensity	100~800cd
Flash Frequency	1~3Hz
Light Quantity	21sets×2
Dimension	632X270X30mm
Weight	6.94kg
Base	PC
Controller	JDX-K3A
Wire Length	6M
Light cover	PC

The left and the right lights are controlled by two independent switches, and also can flash separately or simultaneously.

Arrow Board JDX-1525

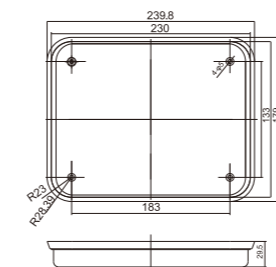
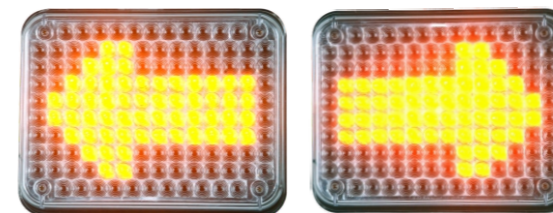

Model	JDX-1525
Rated Voltage (V)	DC12/24V
Current	≤1A
Light Intensity	100~800cd
Flash Frequency	1~3Hz
Light Quantity	56sets×2
Dimension	240X200X30mm
Weight	2.3kg
Base	Steel
Controller	JDX-K3
Wire Length	6M
Light cover	PC

The left and the right lights are controlled by two independent switches, and also can flash separately or simultaneously.



Arrow Board JDX-1584

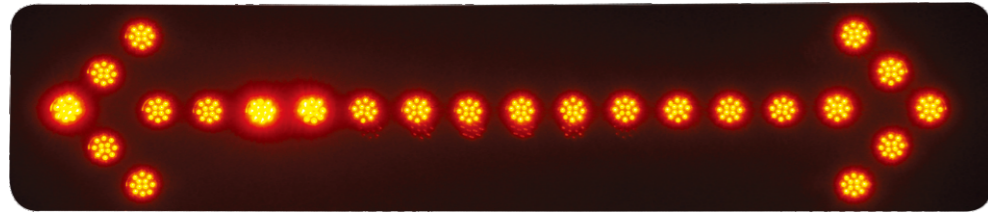

Model	JDX-1584-37
Rated Voltage (V)	DC12/24V
Current	≤3A
Light Intensity	100~800cd
Flash Frequency	1~3Hz
Light Quantity	24sets
Dimension	940X200X77mm
Weight	7.2kg
Base	Steel
Controller	JDX-K2
Wire Length	6M
Light cover	PC

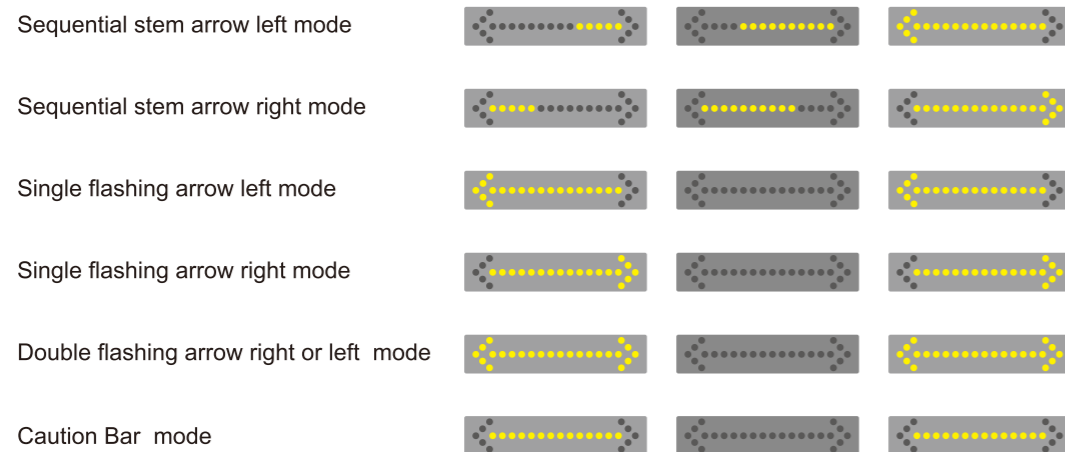
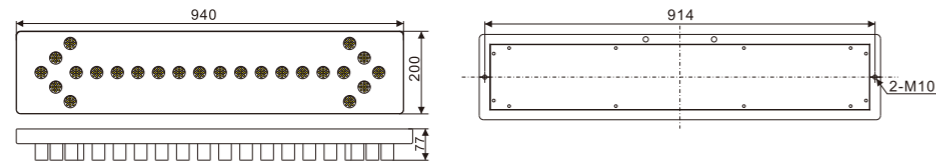

Arrow Board JDX-1584

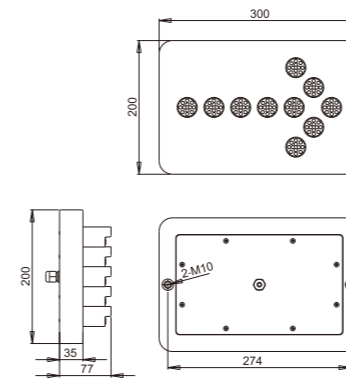

Model	JDX-1584-12
Rated Voltage (V)	DC12/24V
Current	≤3A
Light Intensity	100~800cd
Flash Frequency	1~3Hz
Light Quantity	10setsx2
Dimension	300X200X77mm
Weight	7.2kg
Base	Steel
Controller	JDX-K2
Wire Length	6M
Light cover	PC

The left and the right lights are controlled by two independent switches, and also can flash separately or simultaneously.

Arrow Board JDX-1588

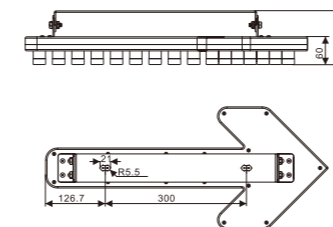

Model	JDX-1588
Rated Voltage (V)	DC12/24V
Current	≤6A
Light Intensity	100~800cd
Flash Frequency	1~3Hz
Light Quantity	40sets×2
Dimension	600X260X60mm
Weight	6.94kg
Base	PC
Controller	JDX-K3
Wire Length	6M
Light cover	PC

The left and the right lights are controlled by two independent switches, and also can flash separately or simultaneously.

Arrow Board JDX-1581

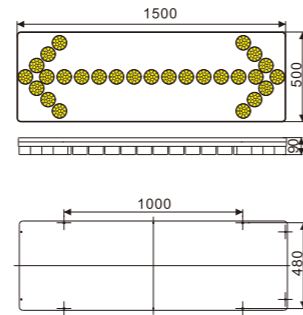

Model	JDX-1581-62
Rated Voltage (V)	DC12/24V
Current	≤2A
Light Intensity	100 ~ 800cd
Flash Frequency	1 ~ 3Hz
Light Quantity	27 sets
Dimension	1500X500X90mm
Weight	24.6kg
Base	Steel
Controller	JDX-K3
Wire Length	6M
Light cover	PC

Arrow Board JDX-1582

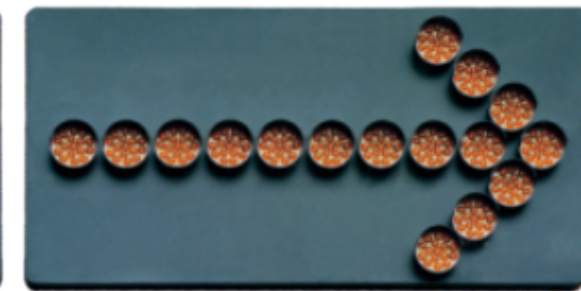
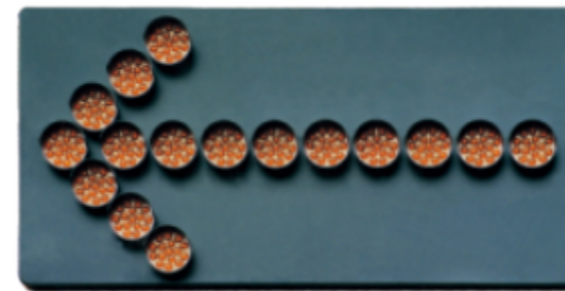

Model	JDX-1582-48
Rated Voltage (V)	DC12/24V
Current	≤3A
Light Intensity	100~800cd
Flash Frequency	1~3Hz
Light Quantity	16 sets
Dimension	1200X500X90mm
Weight	31.5kg
Base	Steel
Controller	JDK-K3
Wire Length	6M
Light cover	PC

The left and the right lights are controlled by two independent switches, and also can flash separately or simultaneously.

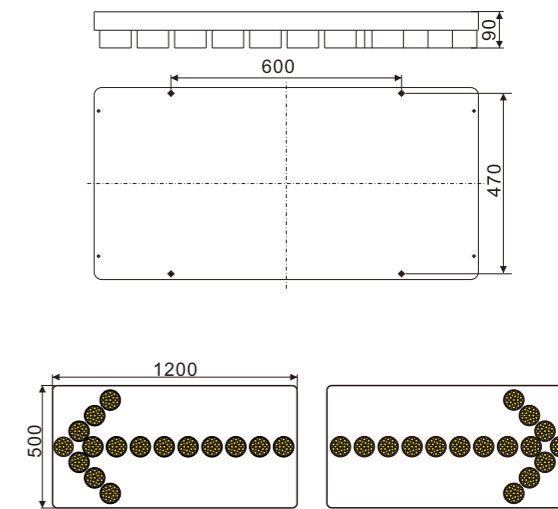
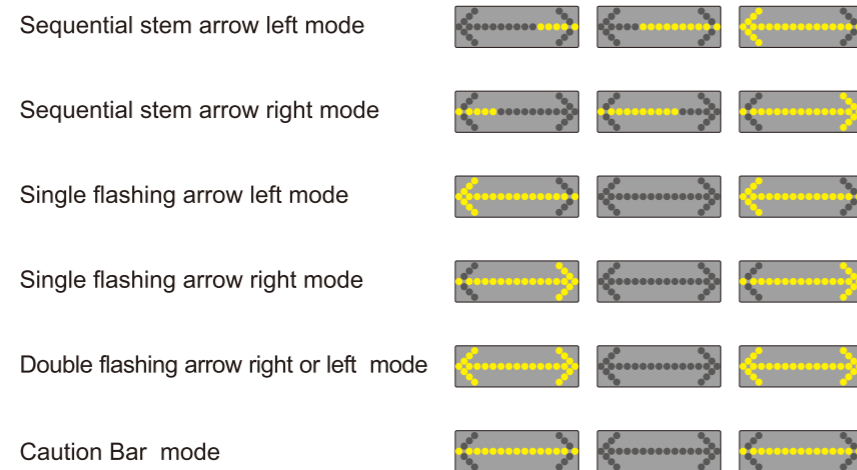

SIREN & SPEAKER SERIES



Siren CJB-8CF

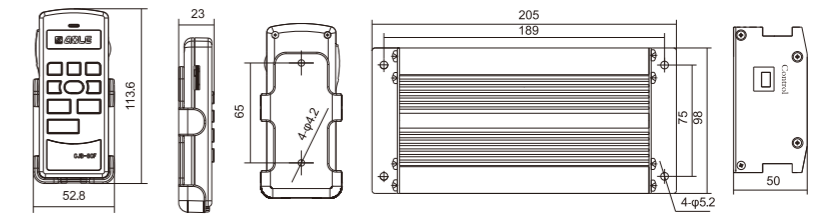

Model	CJB-8CF
Rated Voltage (V)	DC12/24V
Rated Power (w)	80W/100W/150W/200W
Current	≤7A~12.5A
Ambient temperature	-40℃~+65℃
Impedance	4Ω/6Ω/8Ω/11Ω/16Ω
Dimensions(mm)	205X98X50mm
Net weight(kg)	2.1

TONE:WAIL-1,WAIL-2,SIREN,RITE,HORN,YELP,Hi-Lo,TOOT,PHSR

Siren CJB-8AF

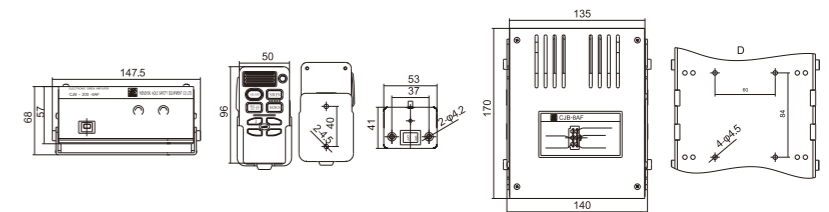

Model	CJB-8AF
Rated Voltage (V)	DC12/24V
Rated Power (w)	80W/100W/150W/200W
Current	≤7A~17A
Ambient temperature	-40℃~+65℃
Impedance	4Ω/6Ω/8Ω/11Ω/16Ω
Dimensions(mm)	140X170X68mm
Net weight(kg)	1.8

TONE:WAIL-1,WAIL-2,SIREN,RITE,HORN,YELP,Hi-Lo,TOOT

Siren CJB-8BF

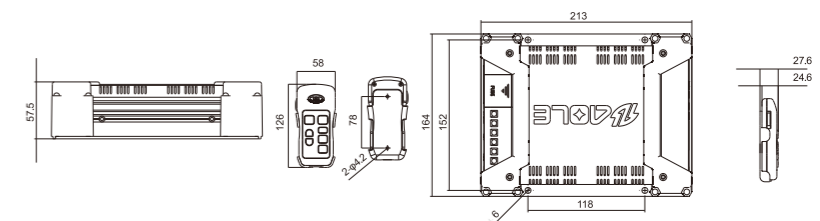

Model	CJB-8BF
Rated Voltage (V)	DC12/24V
Rated Power (w)	80W/100W/150W/200W
Current	≤17A~33.5A
Ambient temperature	-40℃~+65℃
Impedance	4Ω/6Ω/8Ω/11Ω/16Ω
Dimensions(mm)	213*164*57.5
Net weight(kg)	2.1

TONE:WAIL-1,WAIL-2,SIREN,RITE,RITE,YELP,Hi-Lo,TOOT,PHSR



Siren CJB-8K

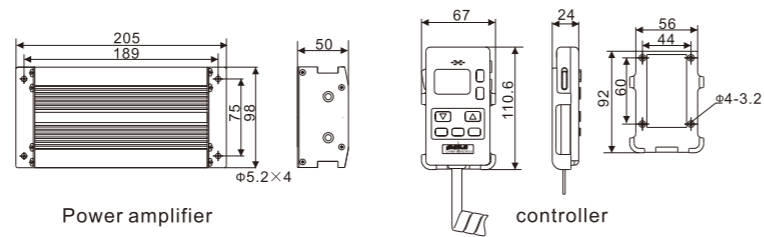

Model	CJB-8K
Rated Voltage (V)	DC12/24V
Rated Power (w)	80W/100W/150W/200W
Current	≤7A~17A
Ambient temperature	-40℃~+65℃
Impedance	4Ω/6Ω/8Ω/11Ω/16Ω
Dimensions(mm)	205*98*50
Net weight(kg)	2.1

TONE:WAIL-1,WAIL-2,SIREN,RITE,HORN,YELP,HI-Lo,TOOT

Siren CJB-8KA

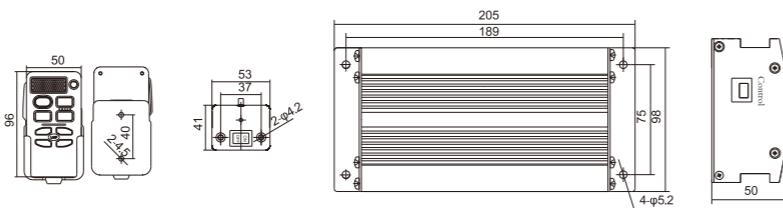

Model	CJB-8KA
Rated Voltage (V)	DC12/24V
Rated Power (w)	80W/100W/150W/200W
Current	≤7A~12.5A
Ambient temperature	-40℃~+65℃
Impedance	4Ω/6Ω/8Ω/11Ω/16Ω
Dimensions(mm)	205X98X50mm
Net weight(kg)	2.1

TONE:WAIL-1,WAIL-2,SIREN,RITE,HORN,YELP,HI-Lo,TOOT

Siren CJB-8KB

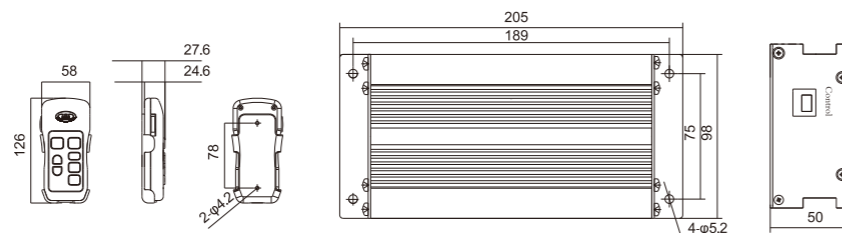

Model	CJB-8KB
Rated Voltage (V)	DC12/24V
Rated Power (w)	80W/100W/150W/200W
Current	≤7A~12.5A
Ambient temperature	-40℃~+65℃
Impedance	4Ω/6Ω/8Ω/11Ω/16Ω
Dimensions(mm)	205X98X50
Net weight(kg)	2.1

TONE:WAIL-1,WAIL-2,SIREN,RITE,RITE,YELP,HI-Lo,TOOT,PHSR

Siren CJB-8AC

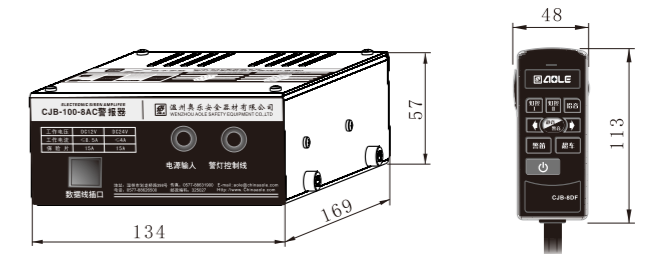

Model	CJB-8AC
Rated Voltage (V)	DC12
Rated Power (w)	80W/100W/150W/200W
Current	≤7A~25A
Ambient temperature	-40℃~+65℃
Impedance	4Ω/6Ω/8Ω/11Ω/16Ω
Dimensions(mm)	134X169X57
Net weight(kg)	2.1

TONE:WAIL-1,WAIL-2,SIREN,RITE,HORN,YELP,HI-Lo,TOOT

Siren CJB-8A

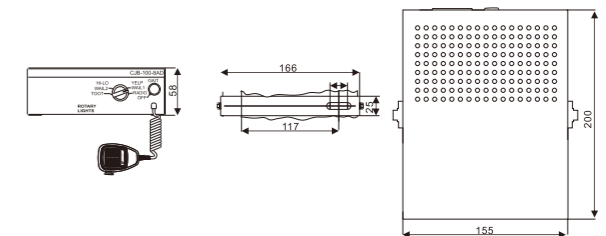

Model	CJB-8A/CJB-8AD
Rated Voltage (V)	DC12V/24V
Rated Power (w)	80W/100W/150W/200W
Current	≤7A~8.5A
Ambient temperature	-40℃~+65℃
Impedance	4Ω/6Ω/8Ω/11Ω/16Ω
Dimensions(mm)	155X200X58
Net weight(kg)	2.1

TONE:WAIL-1,WAIL-2,SIREN,RITE,HORN,YELP,HI-Lo,TOOT,PHSR

Siren CJB-8H

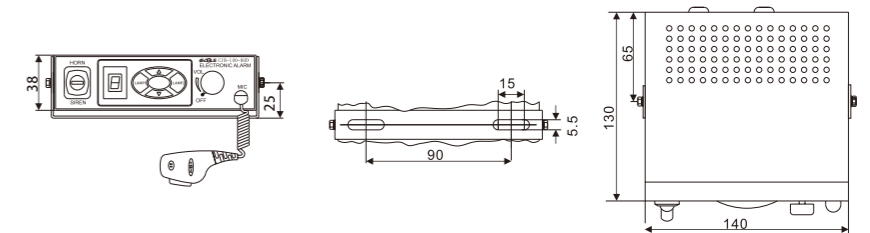

Model	CJB-8H/CJB-8HD/CJB-8HE
Rated Voltage (V)	DC12/24V
Rated Power (w)	80W/100W/150W/200W
Current	≤7A~12.5A
Ambient temperature	-40℃~+65℃
Impedance	4Ω/6Ω/8Ω/11Ω/16Ω
Dimension	140X130X38
Net weight(kg)	1

TONE:WAIL-1,WAIL-2,SIREN,RITE,HORN,YELP,HI-Lo,TOOT

Siren CJB-8I

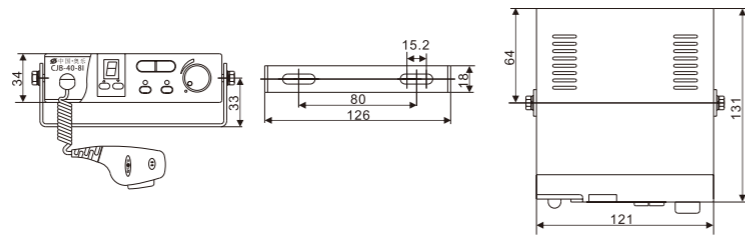

Model	CJB-8I/CJB-8ID
Rated Voltage (V)	DC12/24V
Rated Power (w)	80W/100W/150W/200W
Current	≤3.5-8.5A
Ambient temperature	-40℃~+65℃
Impedance	4Ω/6Ω/8Ω/11Ω/16Ω
Dimensions(mm)	121X131X34mm
Net weight(kg)	1.1

TONE:WAIL-1,WAIL-2,SIREN,RITE,HORN,YELP,HI-Lo,TOOT

Siren CJB-8DF

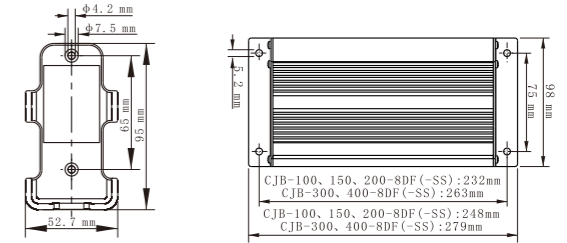

Model	CJB-8DF	CJB-8DF-SS
Rated Voltage (V)	DC12/24V	
Rated Power (w)	100W/150W/200W/300W/400W	
Current	≤4.2-33A	
Ambient temperature	-40℃~+55℃	
Impedance	4Ω/6Ω/8Ω/11Ω/16Ω	
Dimensions(mm)	Controller:49*20*110 Amplifier: 248*98*50	
Net weight(kg)	1.22	1.28

Siren CJB-8T

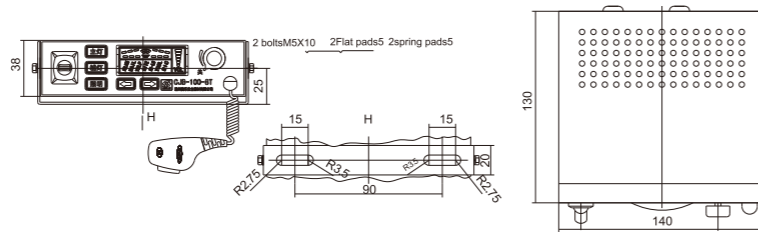

Model	CJB-8T/CJB-8TD/CJB-8TE
Rated Voltage (V)	DC12/24V
Rated Power (w)	80W/100W/150W/200W
Current	≤7-17A
Ambient temperature	-40℃~+65℃
Impedance	4Ω/6Ω/8Ω/11Ω/16Ω
Dimensions(mm)	140X130X38mm
Net weight(kg)	1.8

TONE:WAIL-1,WAIL-2,SIREN,RITE,HORN,YELP,HI-Lo,TOOT

Siren CJB-20-8Y

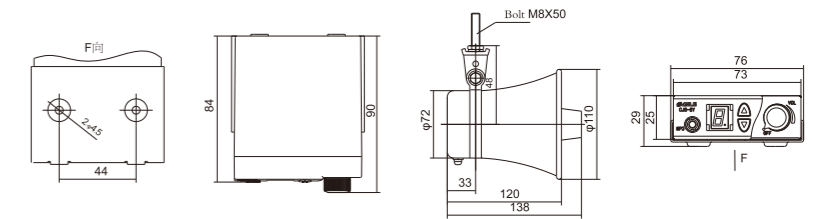

Model	CJB-20-8Y
Rated Voltage (V)	DC12/24V
Rated Power (w)	20W
Current	≤2A
Ambient temperature	-40℃~+65℃
Impedance	8Ω/16Ω
Dimensions(mm)	90*76*29
Net weight(kg)	0.84

Tones: There are 8 optional music; External audio broadcast function

Siren CJB-LB

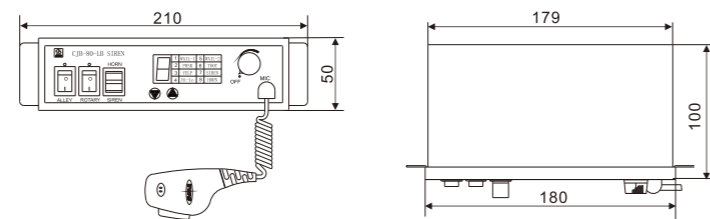

Model	CJB-LB
Rated Voltage (V)	DC12/24V
Rated Power (w)	80W/100W/150W/200W
Current	≤7-8.5A
Ambient temperature	-40℃~+65℃
Impedance	4Ω/6Ω/8Ω/11Ω/16Ω
Dimensions(mm)	180X100X50mm
Net weight(kg)	1.3

TONE:WAIL-1,WAIL-2,SIREN,RITE,HORN,YELP,HI-Lo,TOOT,PHSR

Siren CJB-20-9Y

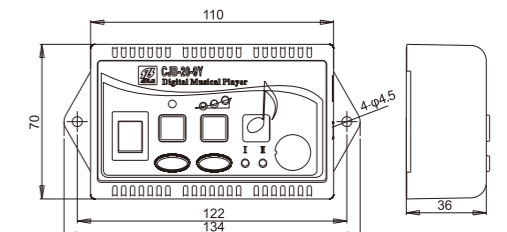

Model	CJB-20-9Y
Rated Voltage (V)	DC12/24V
Current	≤2A
Memory capacity	128M
Ambient temperature	-40℃~+65℃
Impedance	4Ω/8Ω/16Ω
Dimensions(mm)	134*70*36
USB Interface	0.22

Mp3 file format : 1.support all bit rate ISO11172 &ISO113818-3 layer3 audio decoding
2.support 16/22.05/24/32/44.1/48Khz sample rate

Speaker JYH-20-3



Model :	JYH-20-3
Power:	20W
Frequency:	550-5000Hz
Impedance:	4Ω
SPL:	110dB~115dB (A)
Dimensions(mm):	135*135*85
N.W(kg):	1.9

Speaker JYH-20



Model :	JYH-20
Rated Power (w):	200W
Frequency:	300-5000HZ
Impedance:	4Ω
SPL:	122dB-127dB(A)
Dimensions(mm):	206*132*205
N.W(kg):	5.0

Speaker JYH-25



Model :	JYH-25
Rated Power (w):	25W
Frequency:	550-5000Hz
Impedance:	4Ω
SPL:	110dB~115dB (A)
Dimensions(mm):	160*90*90
N.W(kg):	0.4

Speaker JYH-80



Model :	JYH-80
Rated Power (w):	80W
Frequency:	300-5000HZ
Impedance:	16Ω
SPL:	115dB-120dB(A)
Dimensions(mm):	206*132*165
N.W(kg):	2.1

Speaker JYH-80Q



Model :	JYH-80Q
Power:	80W
Frequency:	300-5000HZ
Impedance:	16Ω
SPL:	115dB-120dB(A)
Dimensions(mm):	140*50*113
N.W(kg):	1.7

Speaker JYH-100



Model :	JYH-100
Rated Power (w):	100W
Frequency:	300-5000HZ
Impedance:	8Ω
SPL:	118dB-123dB(A)
Dimensions(mm):	206*132*164.5
N.W(kg):	3.0

Speaker JYH-150

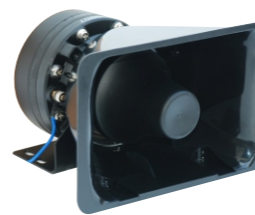

Model :	JYH-150
Rated Power (w):	150W
Frequency:	300-5000HZ
Impedance:	4Ω
SPL:	120dB-125dB(A)
Dimensions(mm):	206*132*186
N.W(kg):	3.5

Speaker JYH-200





Model :	JYH-200
Rated Power (w):	200W
Frequency:	300-5000HZ
Impedance:	4Ω
SPL:	123dB-128dB (A)
Dimensions(mm):	225*150*195
N.W(kg):	3.5

VEHICLE-MOUNTED MOBILE TELESCOPIC LIGHTING EQUIPMENT



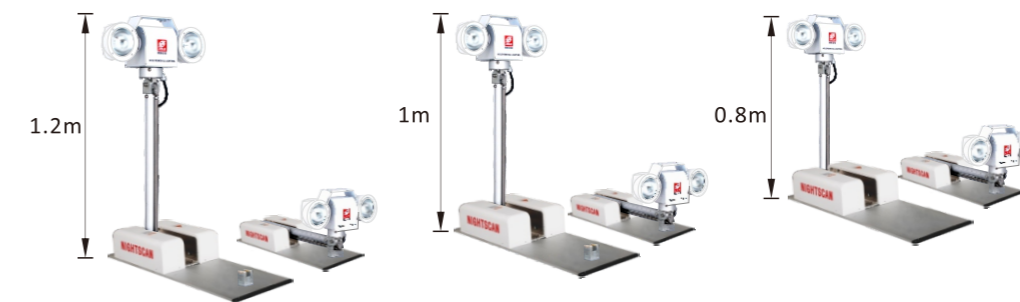
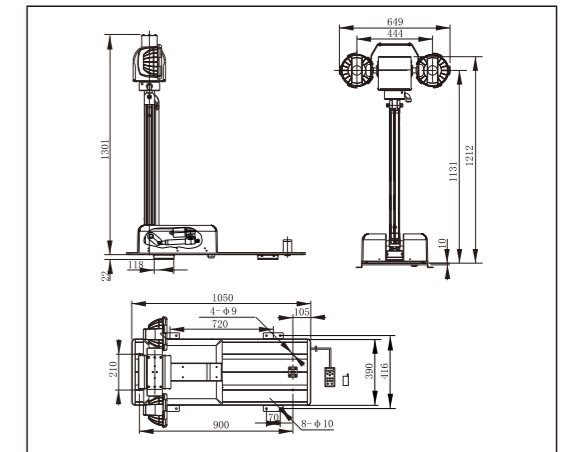

Vehicle-mounted Mobile Telescopic Lighting Equipment

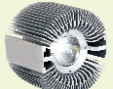

Model	 DT-1 Metal halogen lamp	 DT-6 Xenon lamp	 DT-A LED lamp
Power	75W/150W	55W	30W/100W
Controller	Wired/ Wireless		
Light source	Spotlight/Floodlight/Alternating light		

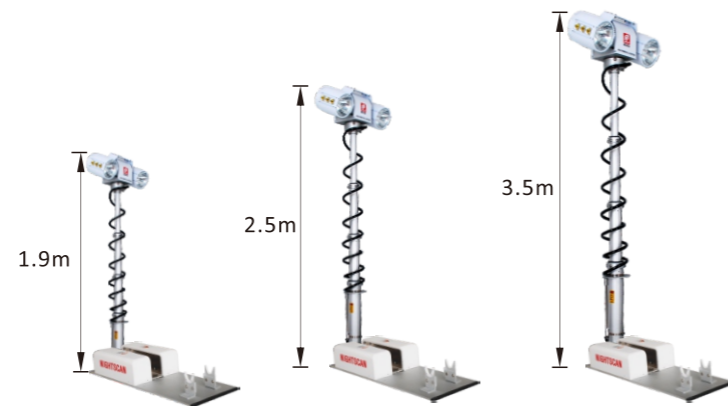
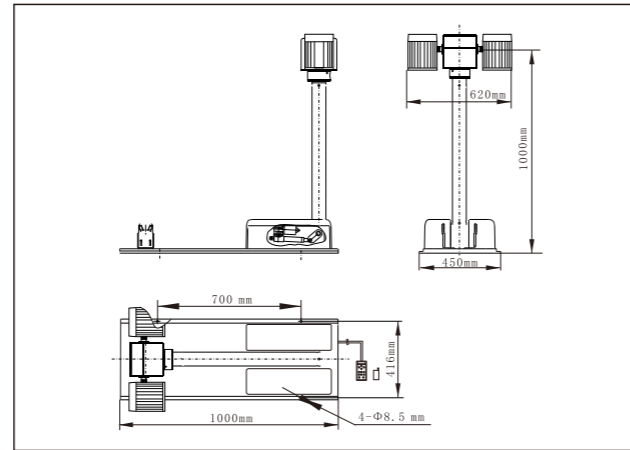
Vehicle-mounted Mobile Telescopic Lighting Equipment

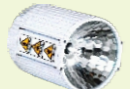

Model	 DT-1 Metal halogen lamp	 DT-6 Xenon lamp	 DT-A LED lamp
Power	75W/150W	55W	30W/100W
Controller	Wired/ Wireless		
Light source	Spotlight/Floodlight/Alternating light		

Rotational Station

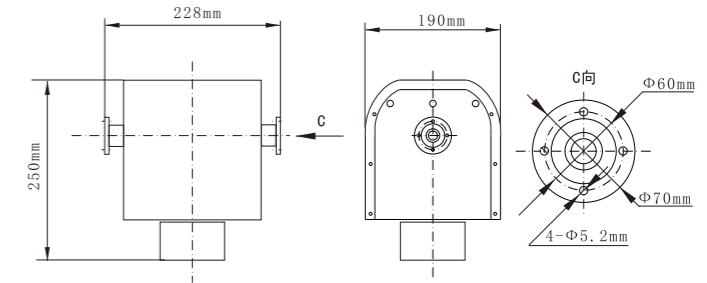

Model	Rated Voltage (V)	Loading ability	Horizontal torque	Vertical torque	Horizontal rotation	Vertical rotation	Additional remarks
YT3	DC12V/24V	35	500	400	365°	180°/ 360°	It is powerful torque and can carry head lamp of 4-6.

Mounting Bracket

- ◆ Mounting bracket is used for Vehicle-mounted mobile telescopic lighting equipment, it can be adjusted according to the shape of vehicle.
- ◆ The product is made of high-strength aluminum and high quality steel plate, the surface is treated with oxidation process and sprayed by plastics coating.
- ◆ It's easy to be mounted, don't need to drill holes in the roof.

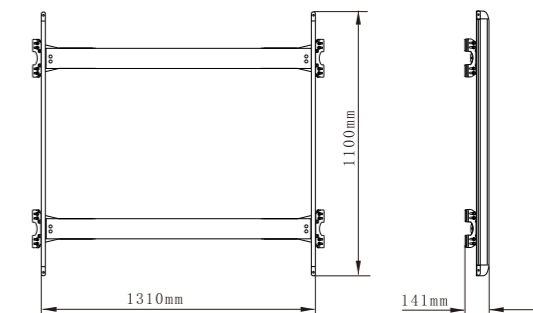



CJJ-10X08

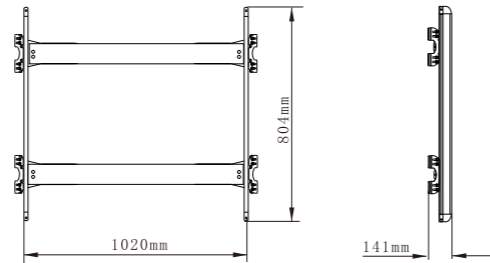

Helmet B-AQ

Big shell riot helmet
Modified Reinforced Polycarbonate&ABS base on first classic Polycarbonate
High strength and toughness,high anti-impact,good heat/cold/acid resistance
Metal net ventilation ear hole and three back ventilation holes
Helmet carrying belt
Gas mask hooks in two side



Helmet B-AL

Big shell riot helmet
Modified Reinforced Polycarbonate&ABS base on first classic Polycarbonate
High strength and toughness,high anti-impact,good heat/cold/acid resistance
Metal net ventilation ear hole and three back ventilation holes
Leather lace edge covered
Gas mask hooks in two side

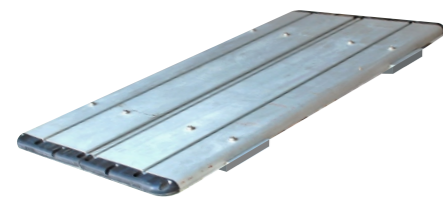

CTX-04X10

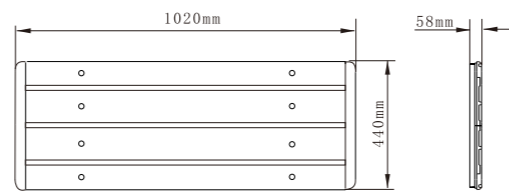

Helmet B-803

Improved reinforced Ploycarbonate & ABS base on first classicPloycarbonate.
High strength and toughness,high anti-impact,good heat/cold/acid resistance.



Helmet B-208

Modified Reinforced Polycarbonate&ABS base on first classic Polycarbonate
High strength and toughness,high anti-impact,good heat/cold/acid resistance
Metal net ventilation ear hole and three back ventilation holes
Gas mask hooks in two side



CTB-04X11

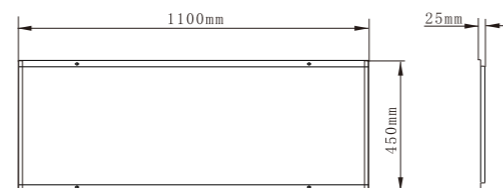

Helmet B-209

whole Molding injection shell,Modified reinforced Ploycarbonate & ABS base on first classic Ploycarbonate. High strength and toughness,high anti-impact,good heat/cold/acid resistance,5 times, more than others(only 2 times paint) ,original paint oil and thinner better than others,supply high bright and high surface harden.



LED Display

MOUNT:VEHICLE/LIGHTBAR



CJXP-51P10B



CJXP-39B



CJXP-30



CJXP-39A

Parking Signal For School Bus



XTP-16D



XCD-K2 Controller



XTP-16



XCD-K2-1 Controller

Parking Signal For School Bus



SCXTP



Service casts reputation
quality decides the future

